

SCALE
1/48
F/A-18E
"VFA-195 Chippy Hol"

12316

ACADEMY
HOBBY MODEL KITS

Warning in Assembly of Model Kits
조립전의 주의사항

Take care not to injure yourself while using the modeling tools to cut or trim parts.
공구를 이용하여 부품을 다듬고 자를 경우, 손을 다치지 않도록 주의를 기울여 주십시오.



CAUTION!
-주의-

<READ THIS BEFORE YOU BEGIN>
<ALLGEMEINE HINWEISE>
<LISEZ CE QUI SUIT AVANT DE COMMENCER LE MONTAGE>
<組み立てる前に>
<조립하기 전에 먼저 읽어 주십시오>

<LISEZ CE QUI SUIT AVANT DE COMMENCER LE MONTAGE>

- Etudier les schémas d'assemblage. - Contrôler que chaque pièce soit bien conforme avant de la coller à sa place.
- N'utilisez pas trop de colle pour réunir les pièces. - Ne jamais manipuler la colle ou peinture à proximité d'une flamme.
- Aérer soigneusement la pièce où vous peignez/ouvrez la fenêtre).
- Après avoir sorti les pièces du sac en plastique, déchirer le sac afin d'éviter que les enfants ne le mettent sur la tête et ne s'étouffent.

<組み立てる前に>

- 組み立てる前に説明書をお読み下さい。 - 部品をランナーから切りはなす時は模型用ニッパーとカッターを使用します。
- 接着剤を少なめに使うことがきれいに仕上がるコツです。 - 接着する前に部品を合わせて確かめます。
- 接着剤や塗料を使用する時はときどき窓を開けて換気をお願いします。
- 組み立て後の部品やビニール袋は小さな子供の手の届かない安全な所に保管して下さい。

■조립하기 전에

- 부품을 조립하기 전에 설명서를 잘 읽어본 후 조립한다.
- 접착하기 전에 부품을 맞추어 확인한 후 조립한다.
- 부품을 자를 때에는 칼이나 니퍼로 깨끗이 잘라준다.
- 접착제를 사용할 곳과 사용하지 않는 곳에 주의하고 너무 많이 바르지 않도록 한다.
- 에나멜 페인트나 접착제를 사용할 때는 창문을 열어 환기를 시키고 화기를 멀리한다.
- 사용 후 남은 부품은 어린 아이들의 손에 닿지 않도록 잘 처리한다.

<READ THIS BEFORE YOU BEGIN>

- Study the instructions before assembling. - Check the fit of each piece before cementing into place.
- Do not use too much cement to join parts. - Never use cement or paint near open flame.
- Open a window or make area well ventilated when cement or paint is in use.
- Tear up and throw away the empty plastic bags to avoid danger of suffocation for little children.

<ALLGEMEINE HINWEISE>

- Die Anordnung der Bauteile ist aus den Zeichnungen der Anleitung ersichtlich.
- Die Teile vor dem Verkleben ungeleimt zusammenhalten, um ihren paßsitz zu prüfen.
- Klebstoff nicht zu dick auftragen. - Klebstoff und Farben niemals in der Nähe einer Flamme verwenden.
- Während der Bemalung mit Spritzpistole oder Pinsel für frische Luftzufuhr, z.B. öffnen des Fensters, sorgen.
- Bausatz von kleinen Kindern fernhalten. Verhüten Sie, daß Kinder irgendwelche Bauteile in den Mund nehmen oder Plastiktüten über den Kopf ziehen.

CEMENT

접착제 사용

CEMENT

접착제 금지

X2

수만큼 조립

DECAL

전사지

BALLAST

무게추

FILL

채움

CUT

잘라냄

OPT

선택

OPPOSITE

반대측 조립

HOLE

뚫어줌

CAUTION

주의

ver.1

버전

MAIN COLOR

5 LIGHT GHOST GRAY FS 36375 라이트 고스트 그레이

6 DARK GHOST GRAY FS 36320 다크 고스트 그레이

PAINT INDEX

			Humbrol				GSI Creos		Lifecolor	TESTORS / MODELMASTER		Revell		Vallejo		
			ENAMEL	ACRYL	AQUEOUS	HOBBYCOLOR	Mr. COLOR			ENAMEL	ACRYL	ENAMEL	ACRYL	MODEL COLOR	MODEL AIR	
1	FLAT BLACK	FS 37038	33	33		H12	33	LC02	1749	4768	32108	36108	950	57		무광검은색
2	GLOSS BLACK	FS 17038	21	21		H2	2	LC72	1747	4695	32107	36107	861			유광검은색
3	YELLOW	FS 13538	188			H329	329	LC53	1707	4683	32310	36310	953	2		노란색
4	RADOM TAN	FS 33613	148			H318	318		1709	4722	32371	36371	917	74		레이돌 탄
5	LIGHT GHOST GRAY	FS 36375	127	127		H308	308	UA026	1728	4762	32143	36143	989	50		라이트 고스트 그레이
6	DARK GHOST GRAY	FS 36320	128	128		H307	307	UA027	1741	4761	32374	36374	905	47		다크 고스트 그레이
7	DARK GULL GRAY	FS 36231	140			H317	317	UA033	1740	4755	32179	36179	991			다크 걸 그레이
8	SILVER	FS 17178	11	11		H8	8	LC74	2914	4678	32190	36190	997	63		은색
9	STEEL	FS 17200	53	53		H18	28	LC76	1795	4681	32191	36191	863	72		스틸
10	BURNT IRON					H76	61		1424	4216						번트아이언
11	CLEAR RED					H90	47		1321	4730			934			투명빨간색
12	CLEAR ORANGE					H92	49									투명주황색
13	CLEAR GREEN						138									투명녹색
14	WHITE	FS 17875	22	22		H316	316	LC51	1745	4696	32104	36104	842			흰색
15	OLIVE DRAB	FS 34087	155			H304	304	UA003	1711	4728	32146	36146	887	43		올리브드랍
16	KHAKI	FS 30277	26	26		H336	336	UA304	1704	4711	32189	36189	879	23		카키

1



접착제 사용

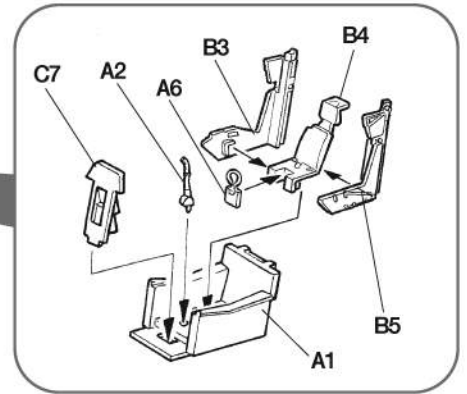
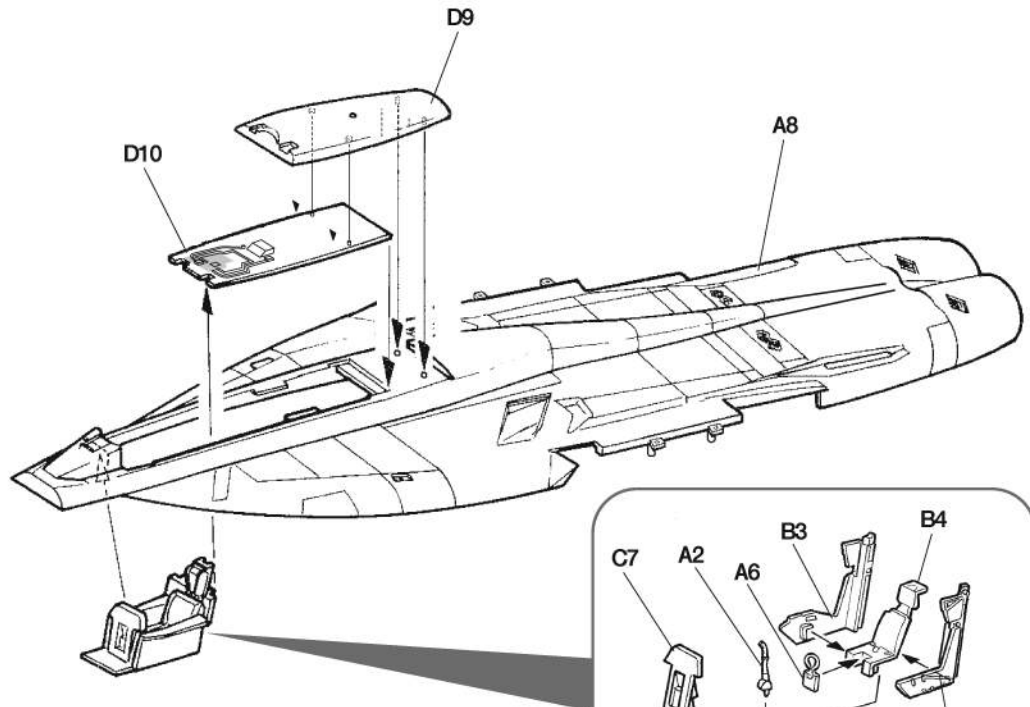
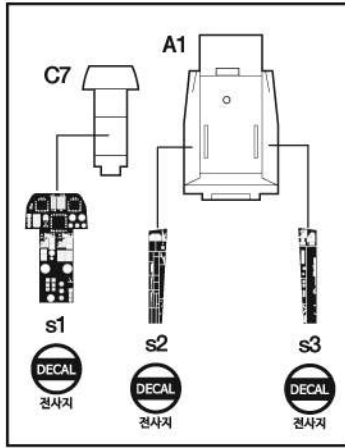

2



접착제 사용

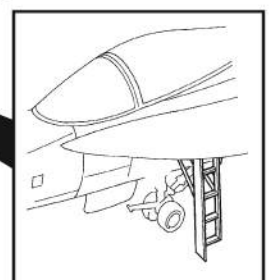
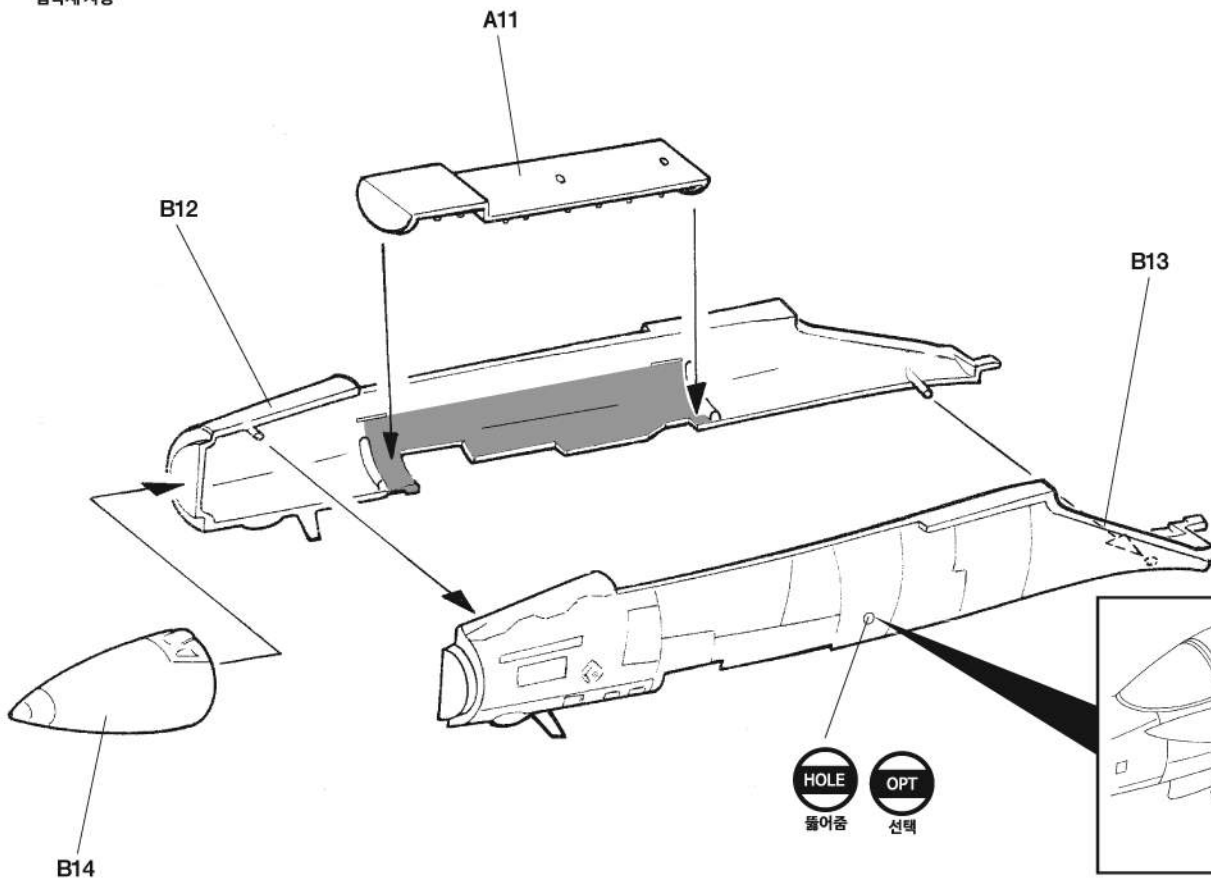

3

CEMENT

접착제 사용

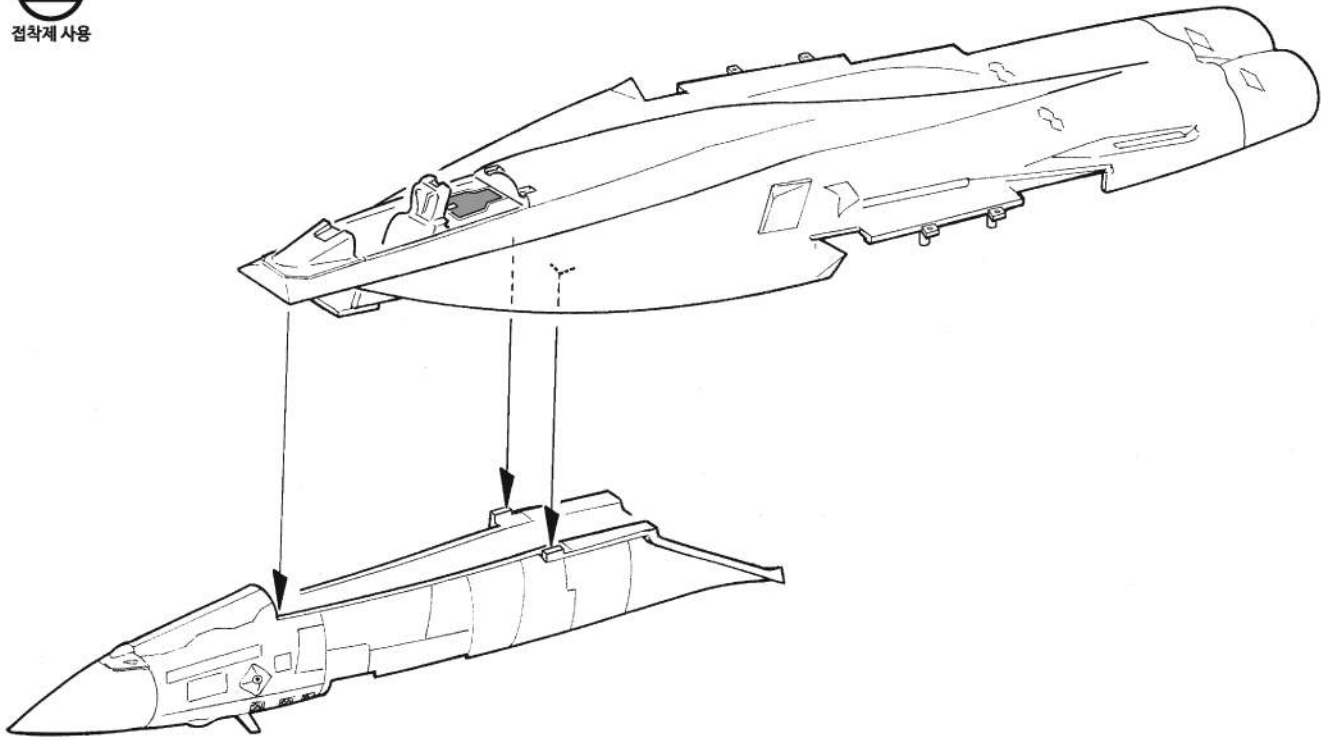

4

CEMENT

접착제 사용

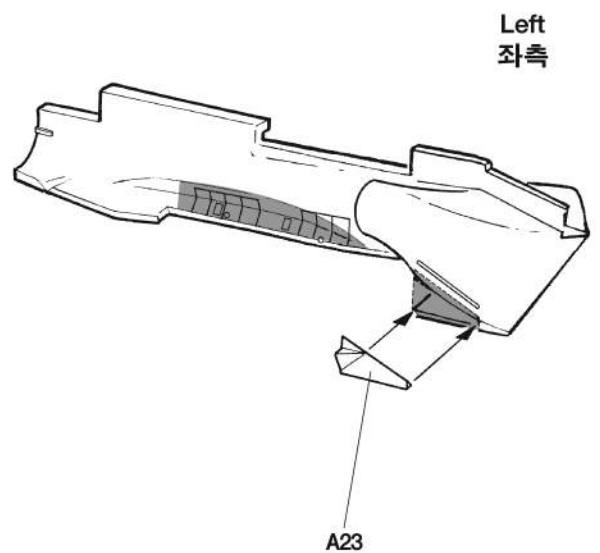
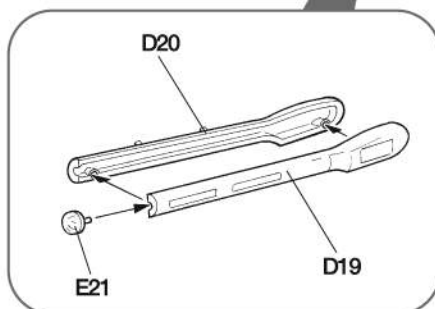
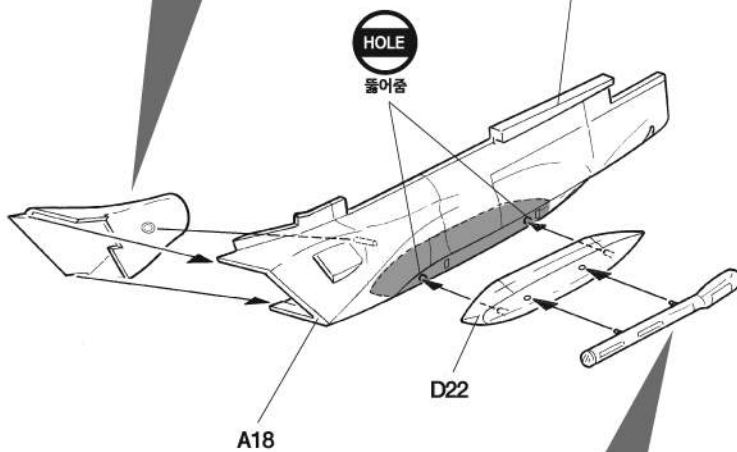
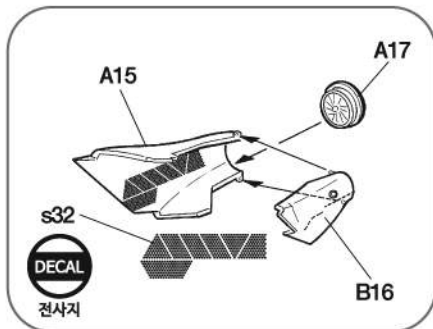

5

CEMENT

접착제 사용

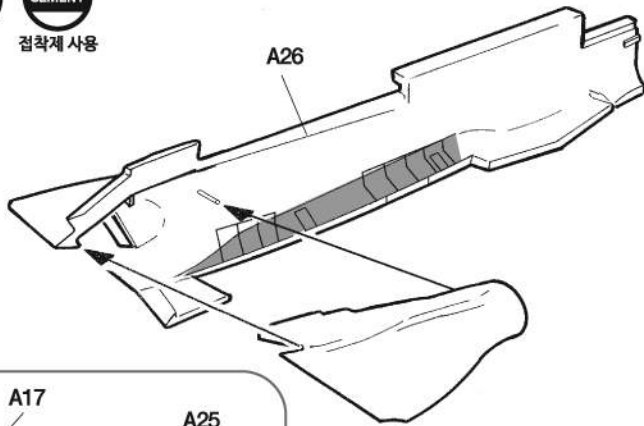

Right
우측

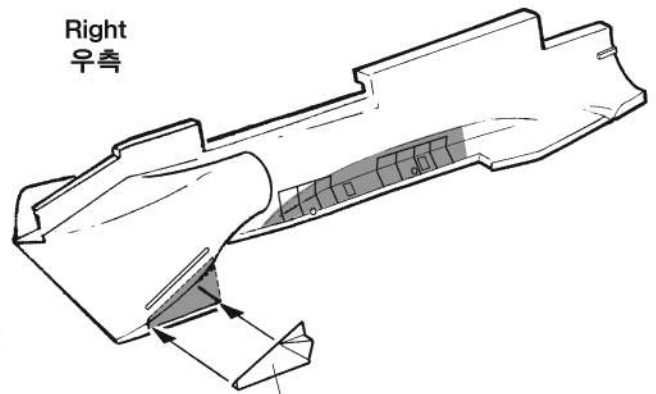

A27

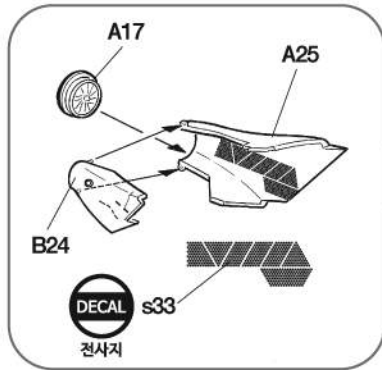

6

CEMENT

접착제 사용

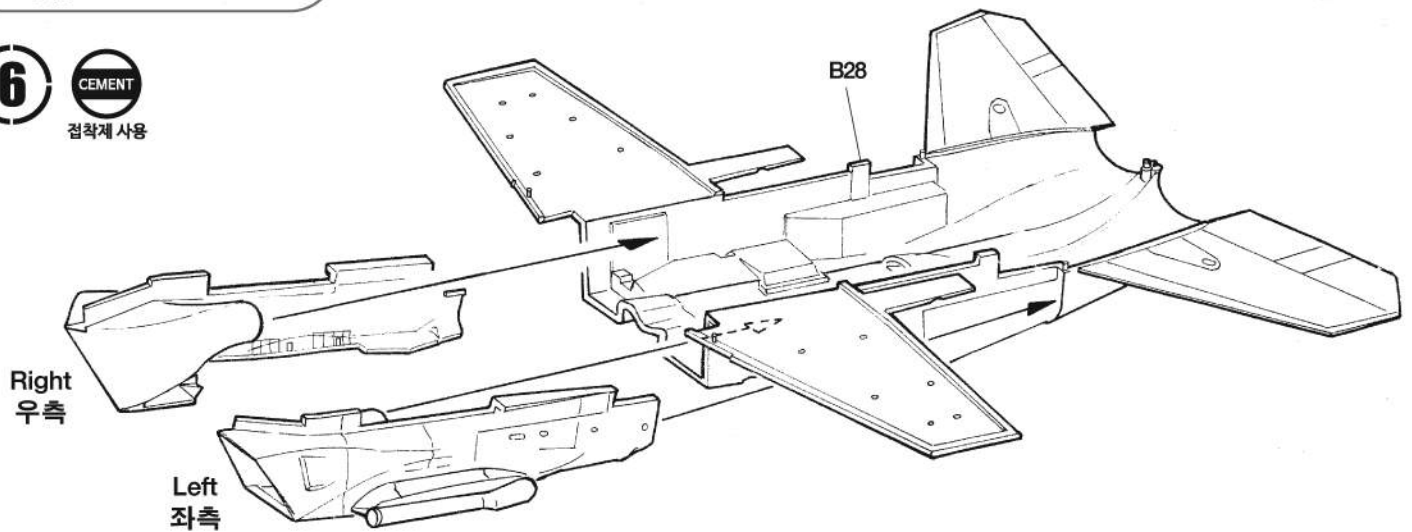

7

CEMENT

접착제 사용

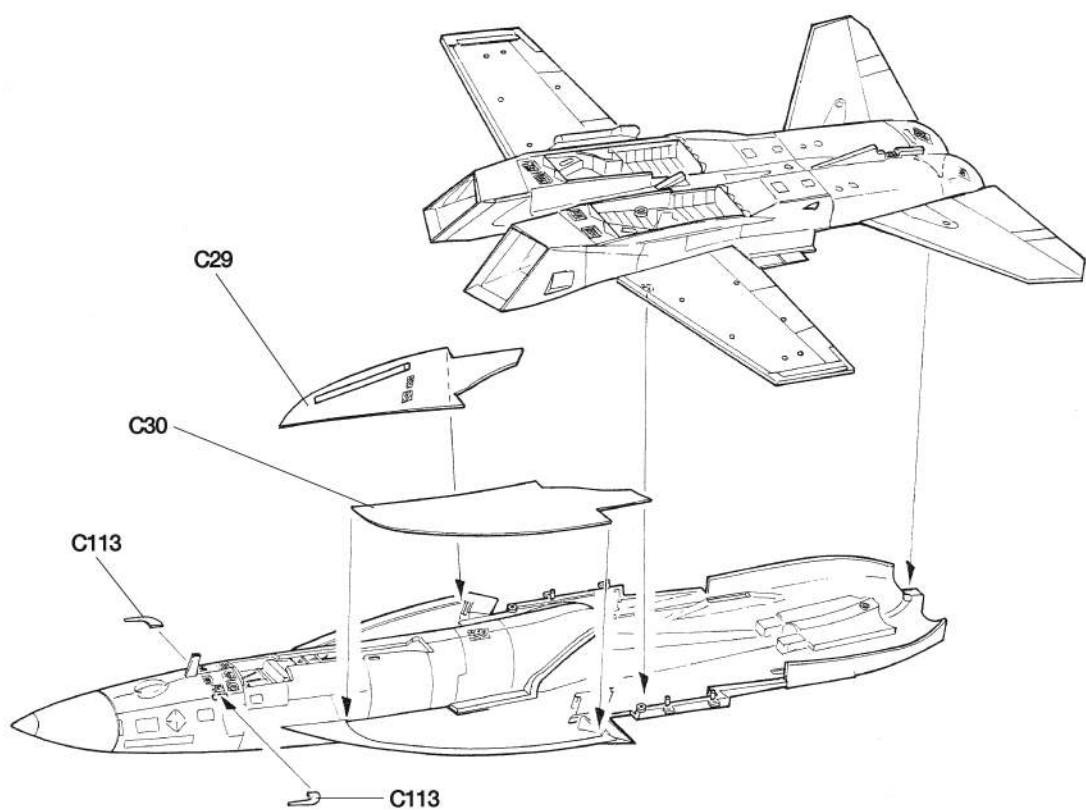

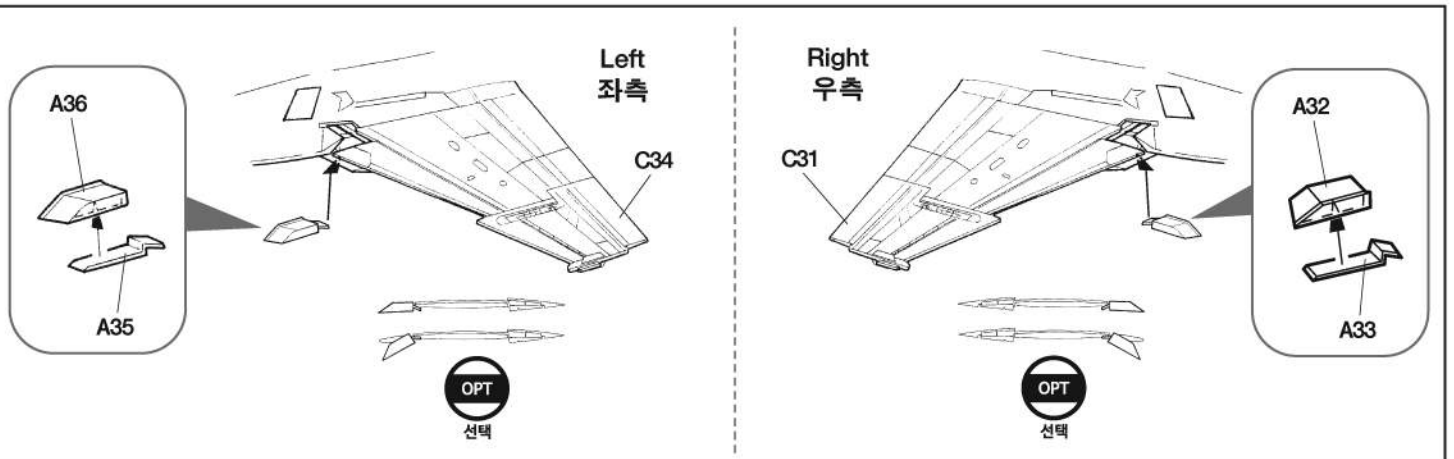
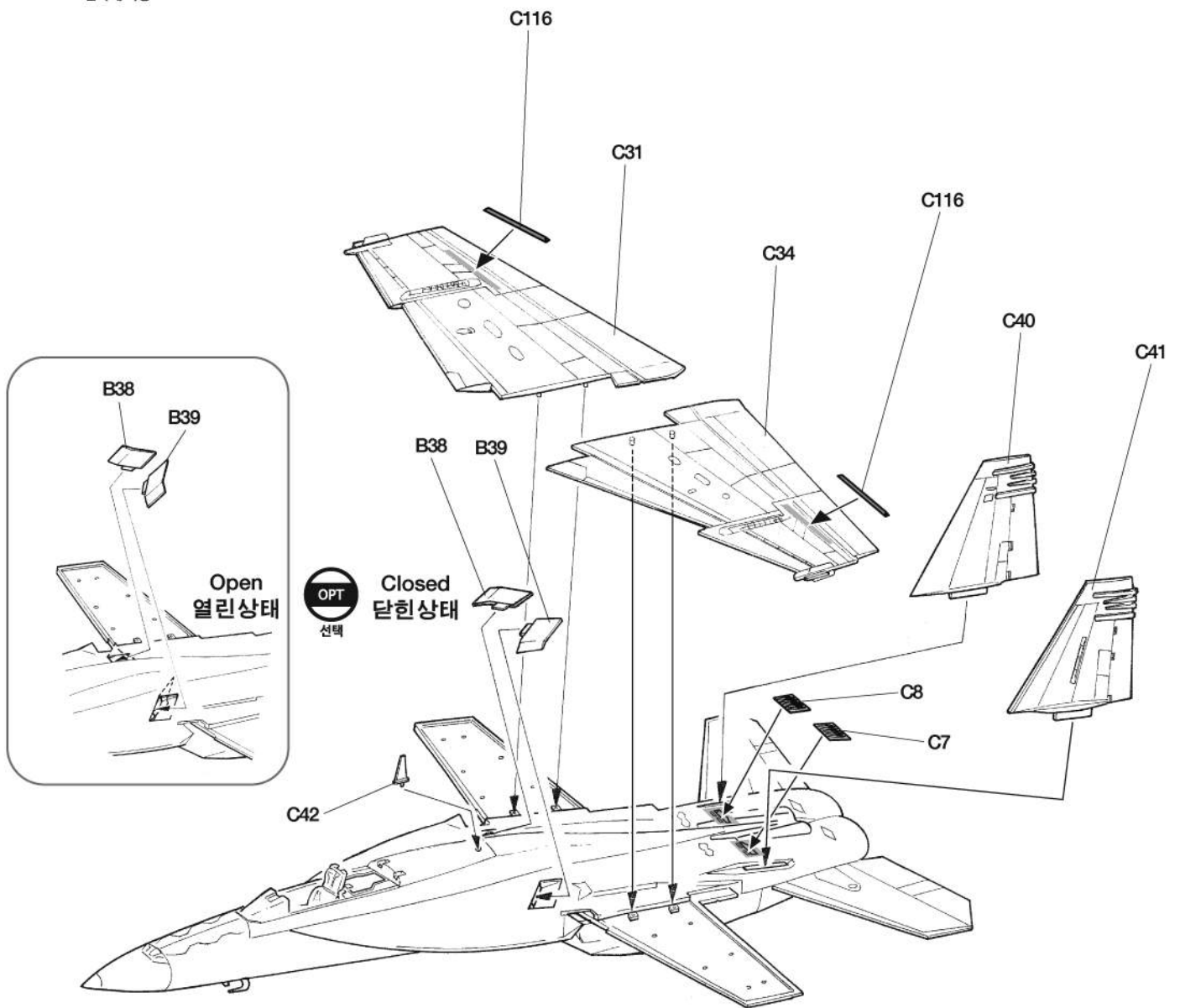

9



접착제 사용

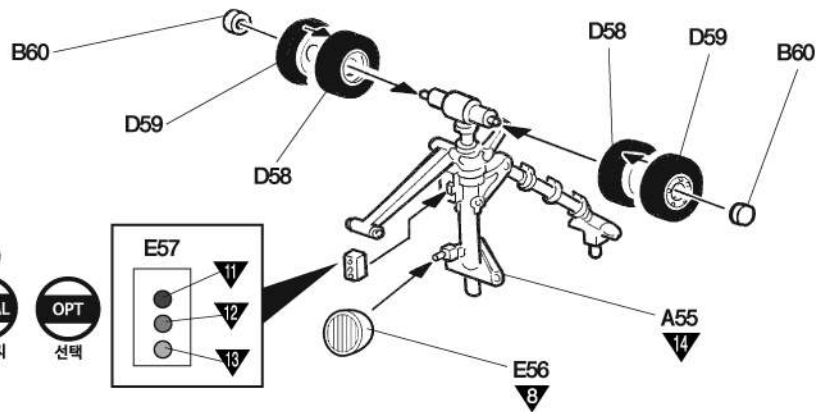
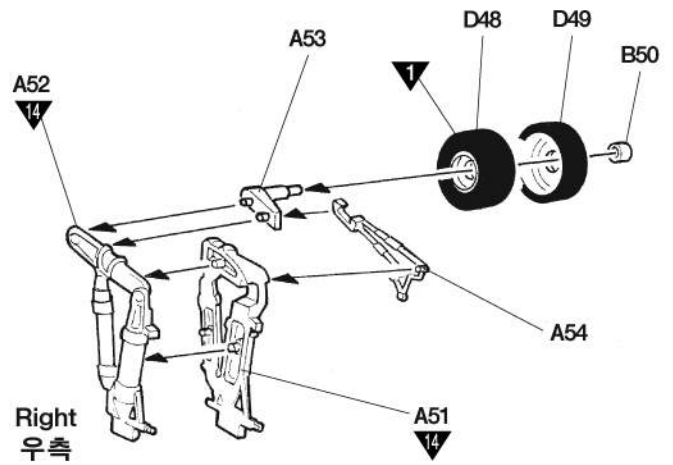
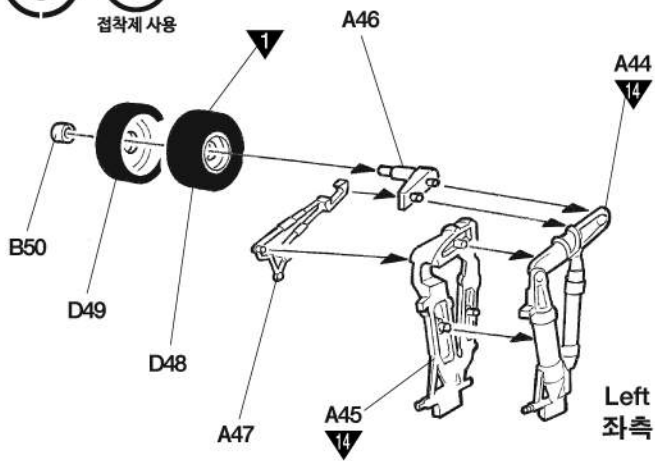

s30

DECAL

전사지

OPT

선택

10



접착제 사용

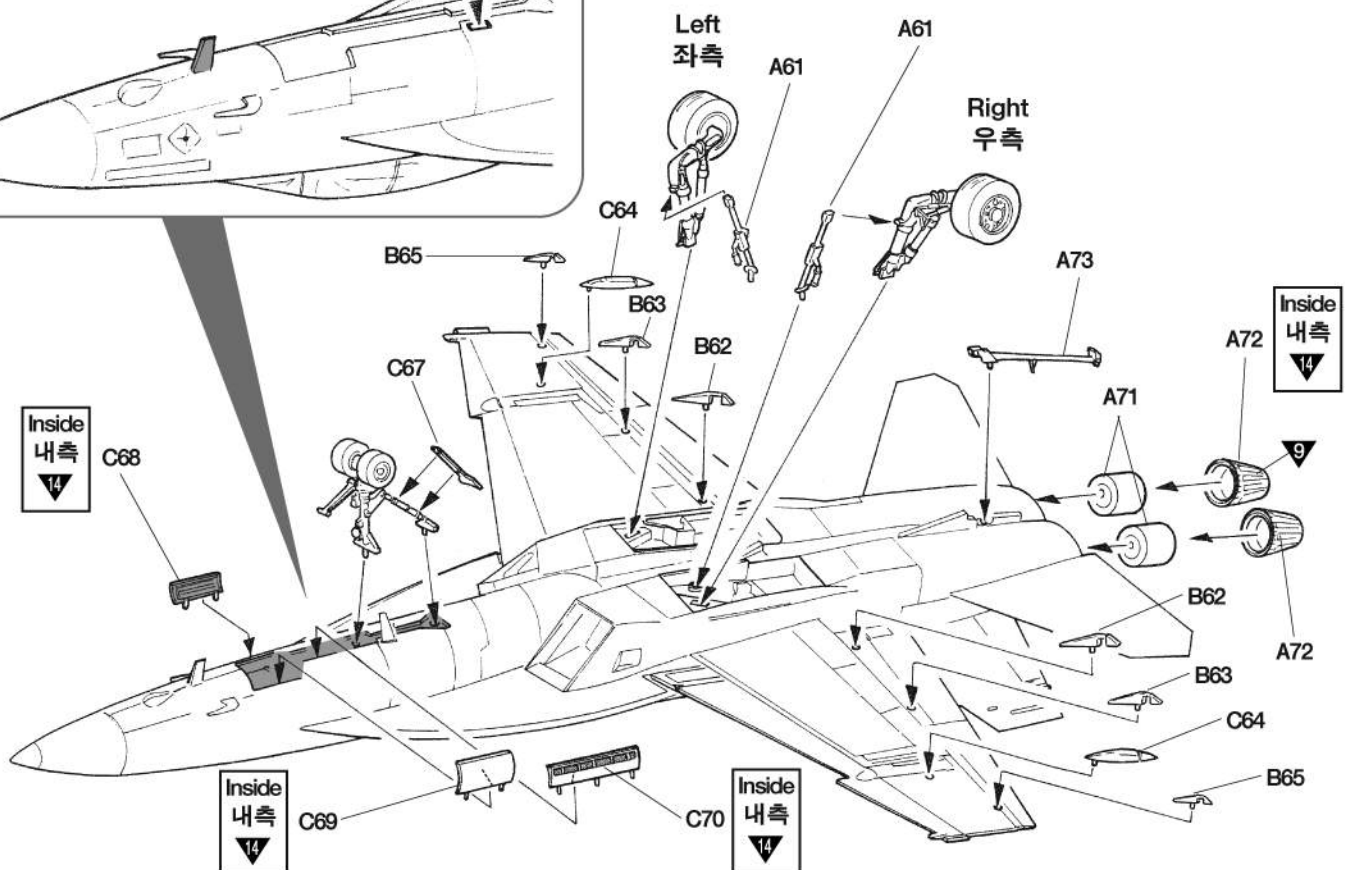
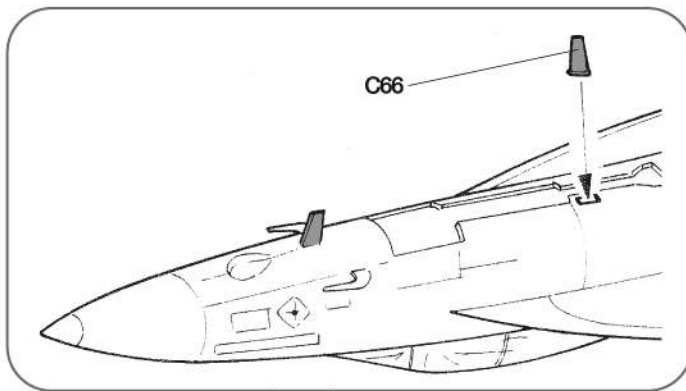

11 CEMENT
접착제 사용

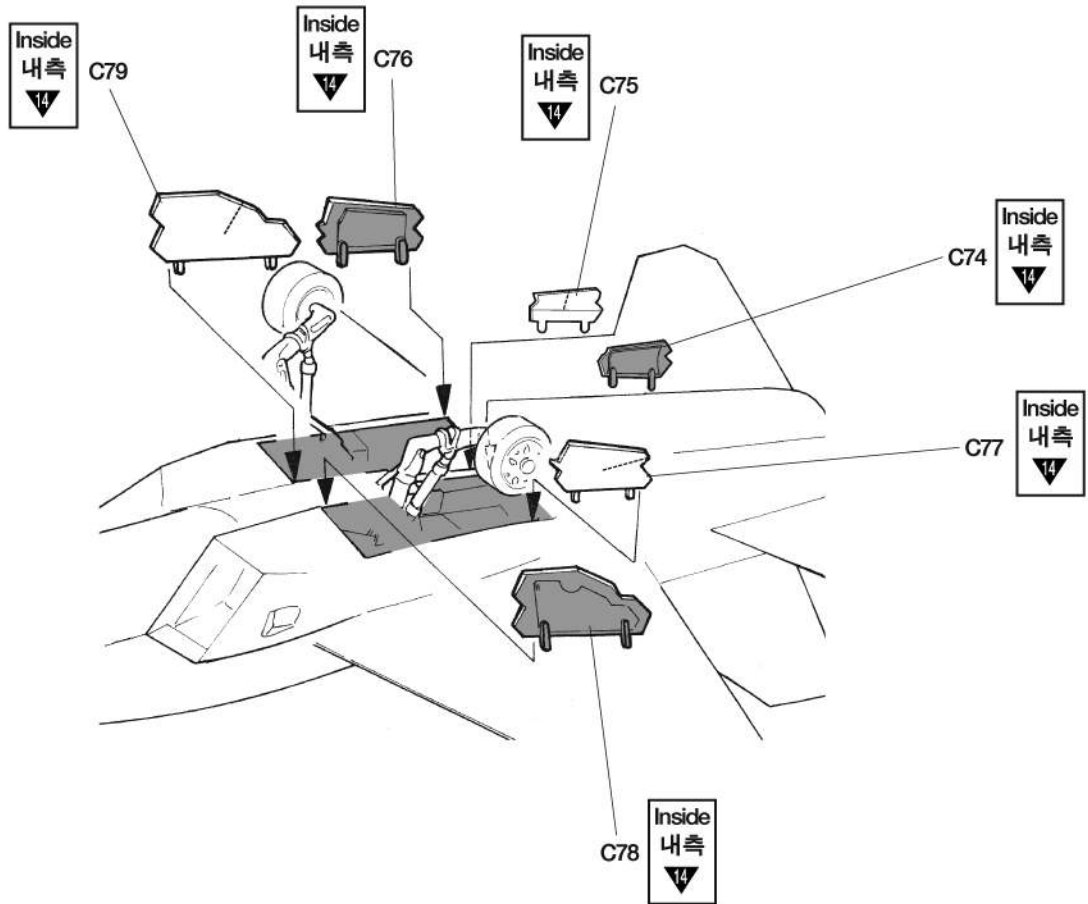

12 CEMENT
접착제 사용

< GBU-38 >

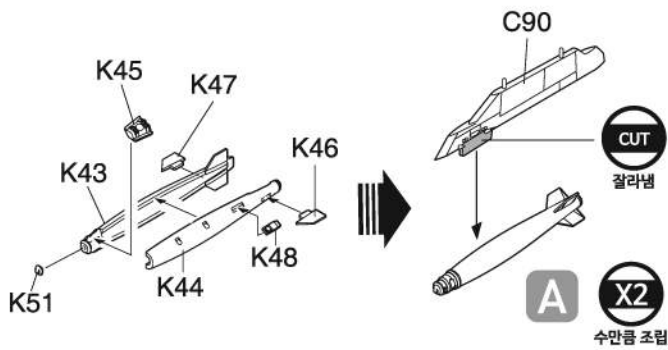

< GBU-12 >

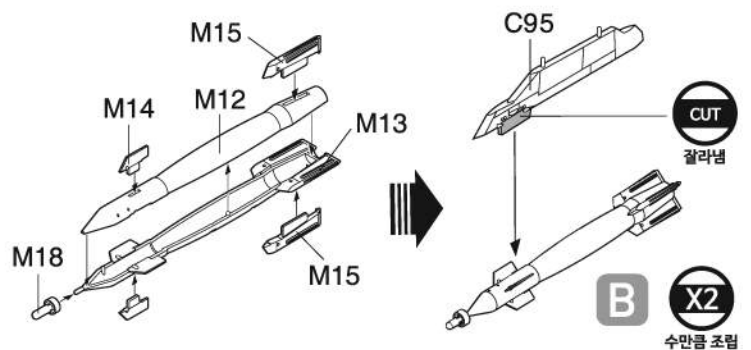

< CENTERLINE FUEL TANK >

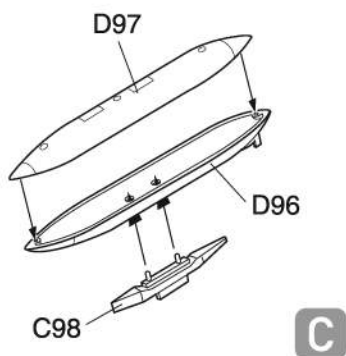

< AIM-9X >

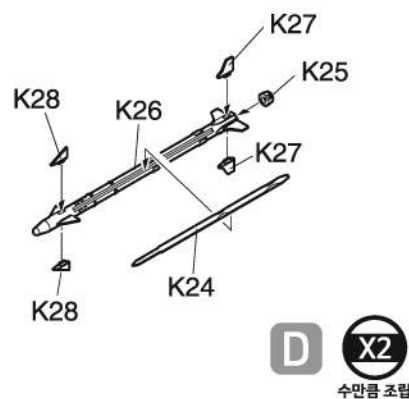

< AIM-120 C >

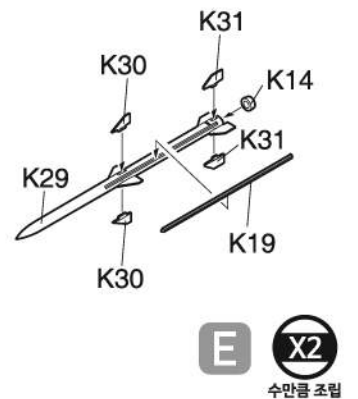

13

CEMENT

접착제 사용

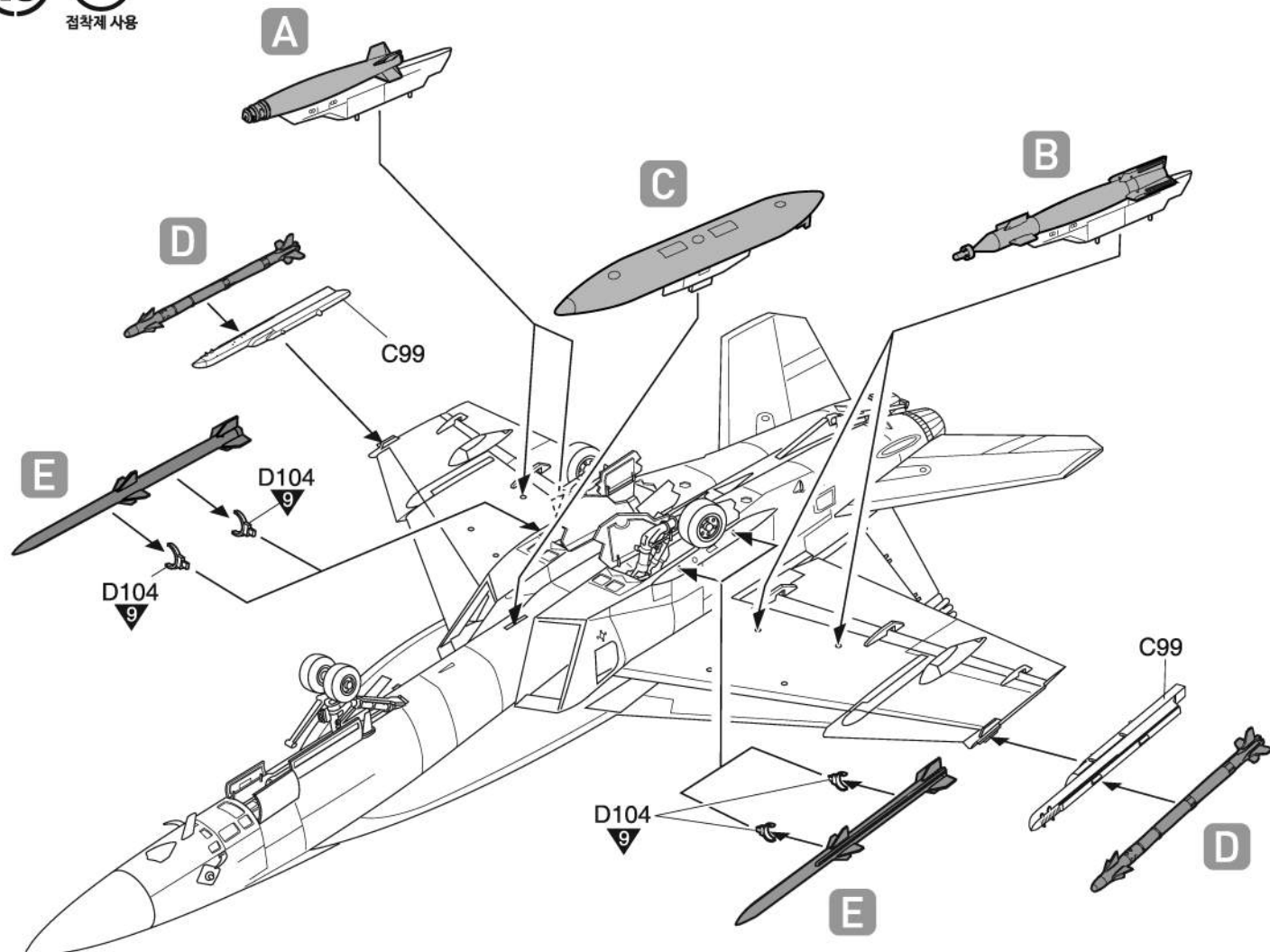

14

CEMENT

접착제 사용

Open
열린상태

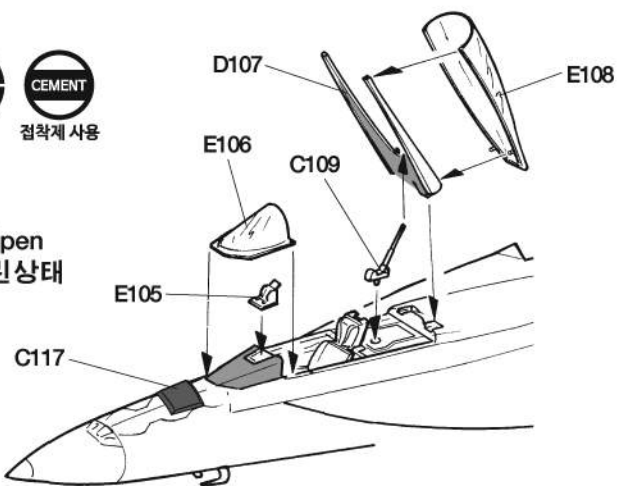

Closed
닫힌상태

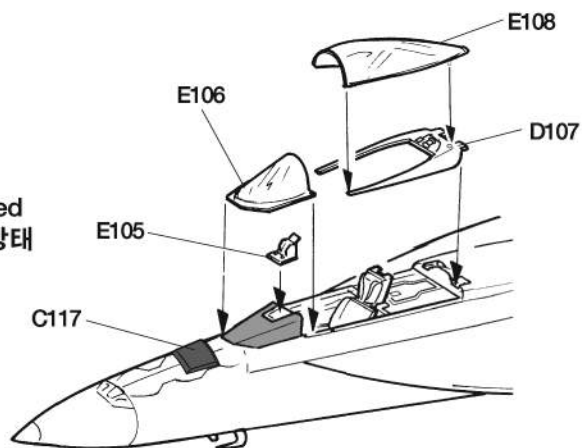

OPT

선택

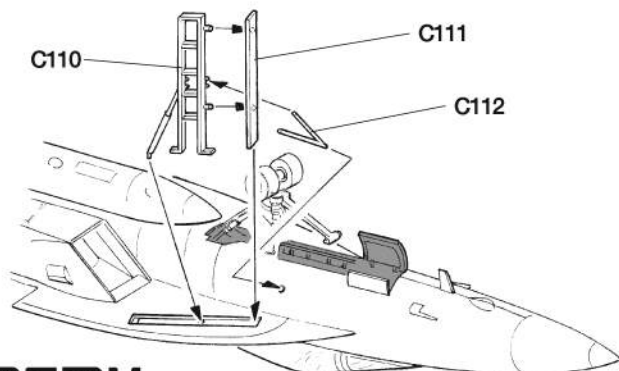
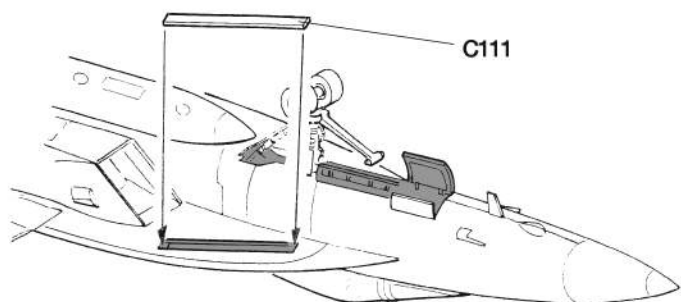

MANUAL 1

MANUAL 2

※ To be continued manual second time!
두번째 설명서로 이어집니다!

ACADEMY
HOBBY MODEL KITS

ACADEMY
ACADEMY PLASTIC MODEL CO., LTD.
521-1, Yonghyeon-dong, Uijeongbu-si, Gyeonggi-do, Korea
고객상담센터: 031-850-8555

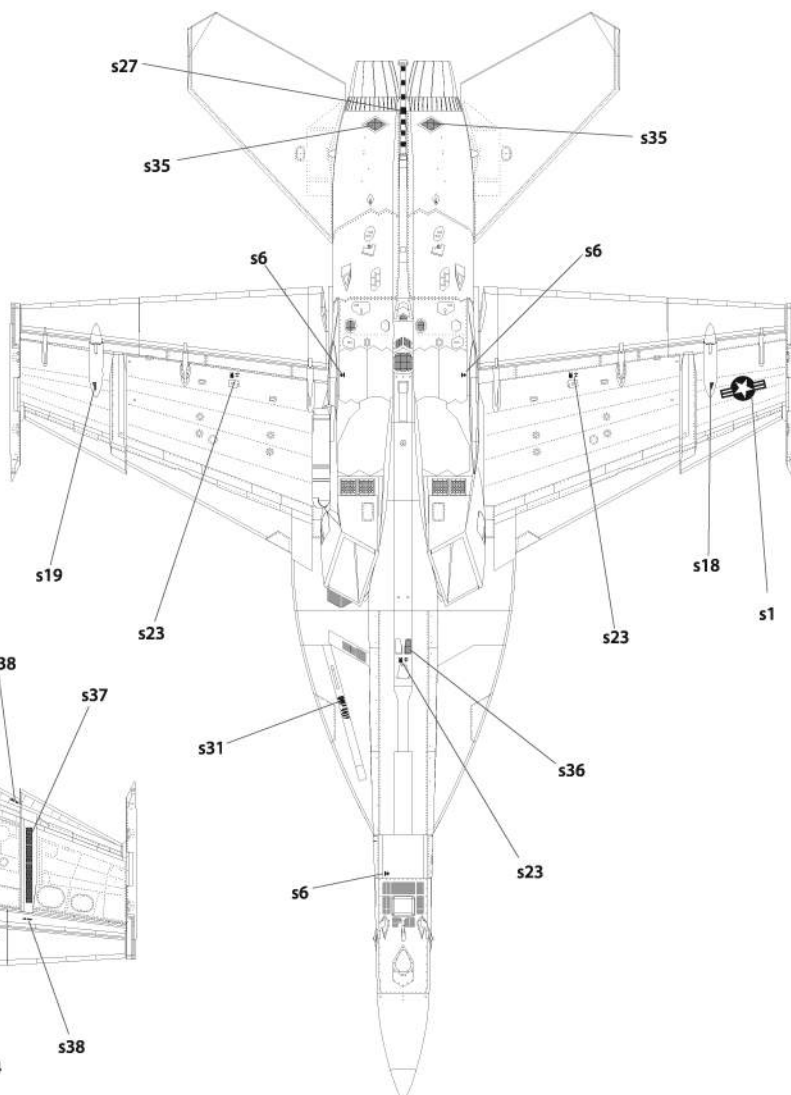
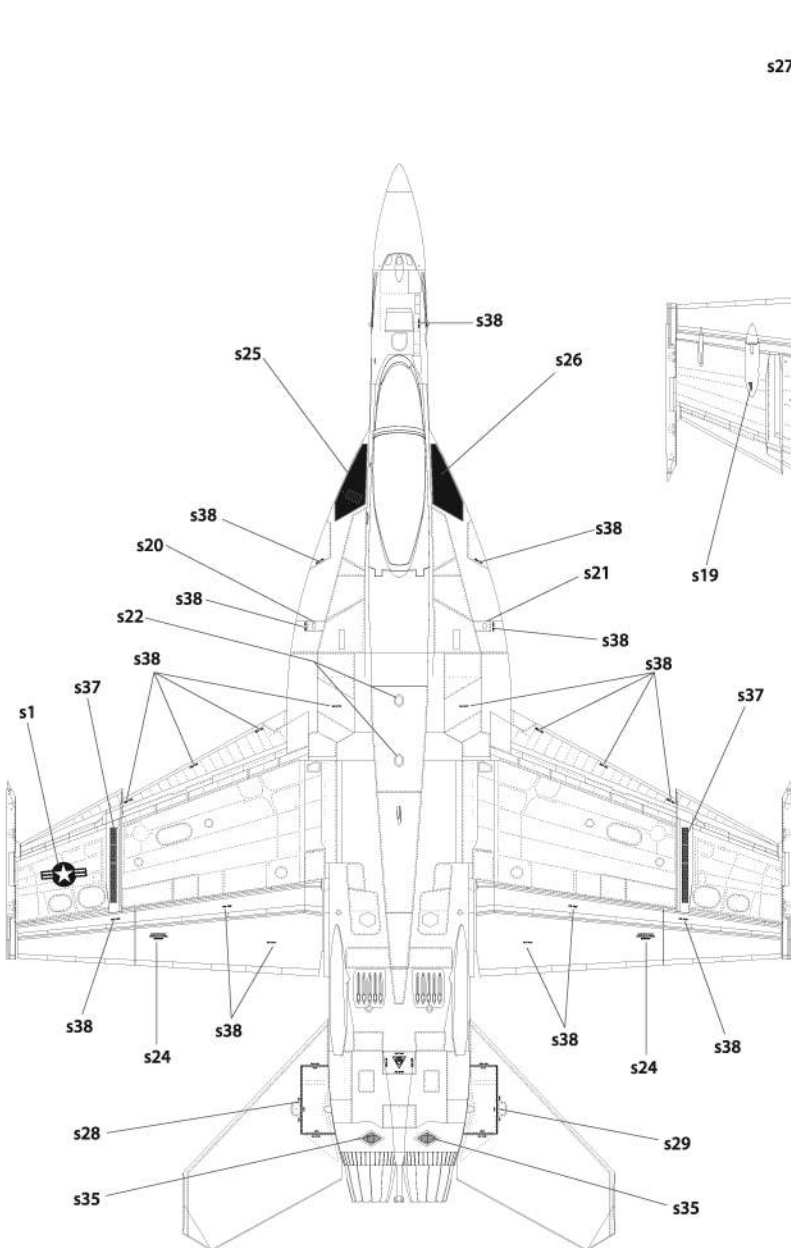
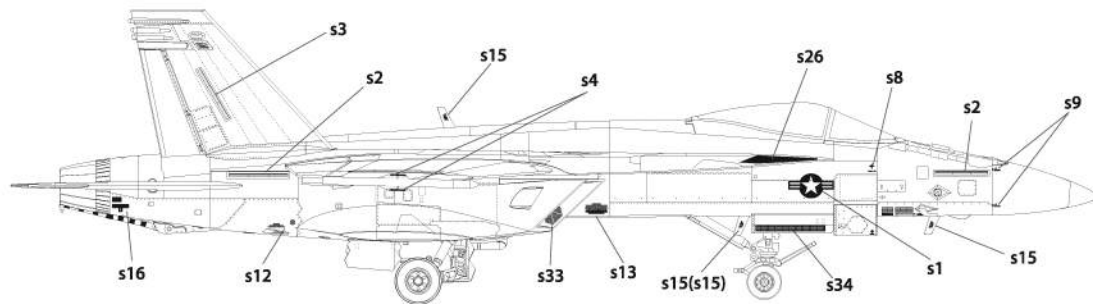
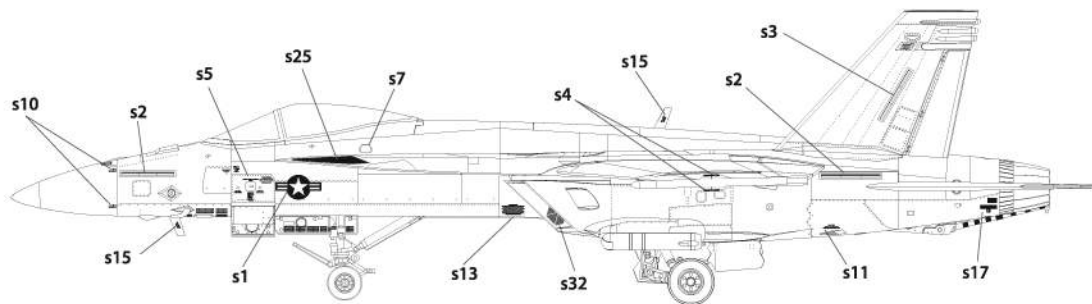

● F/A-18E VFA-195 "DAMBUSTERS" 166901 CAG, April, 2012

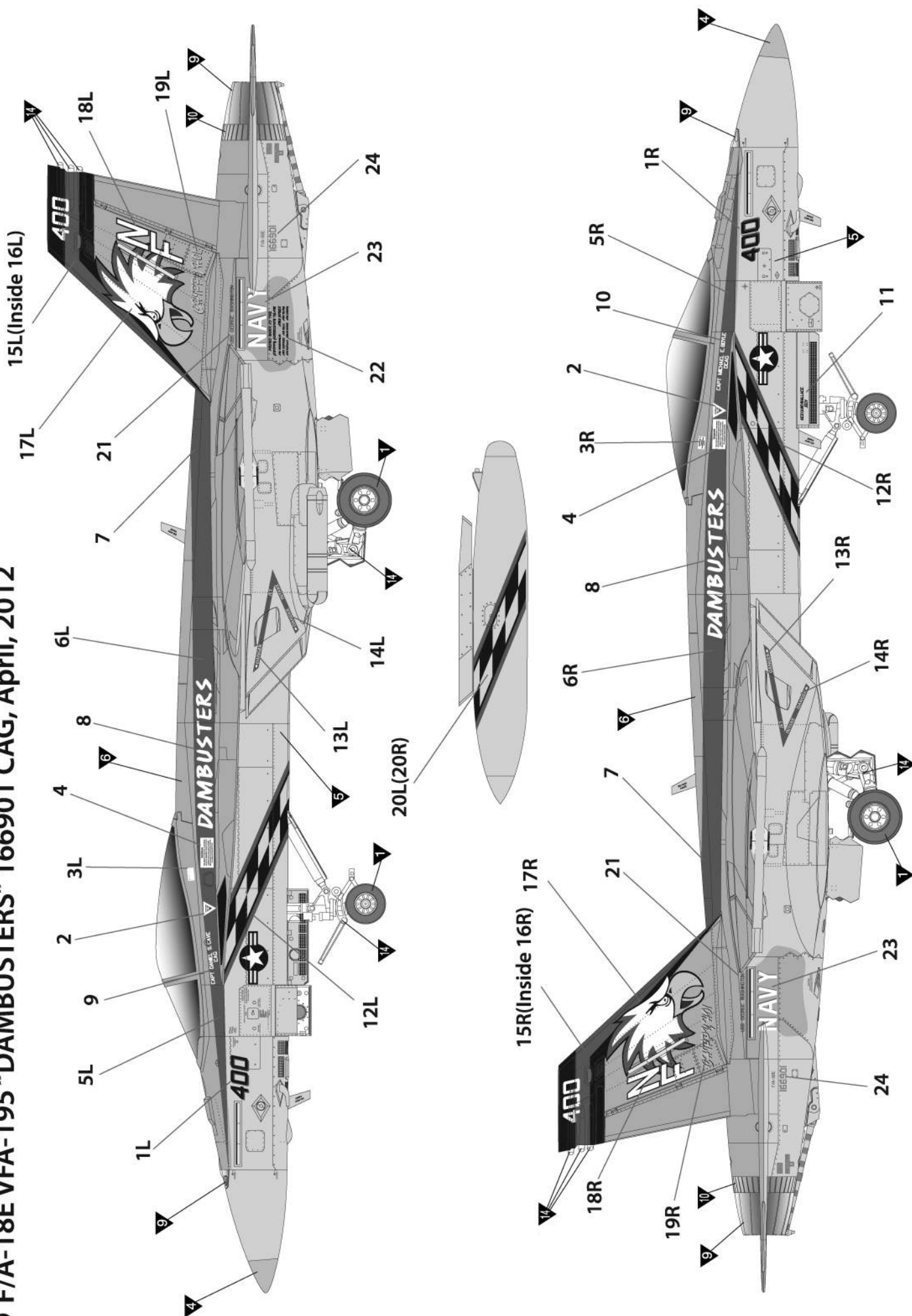

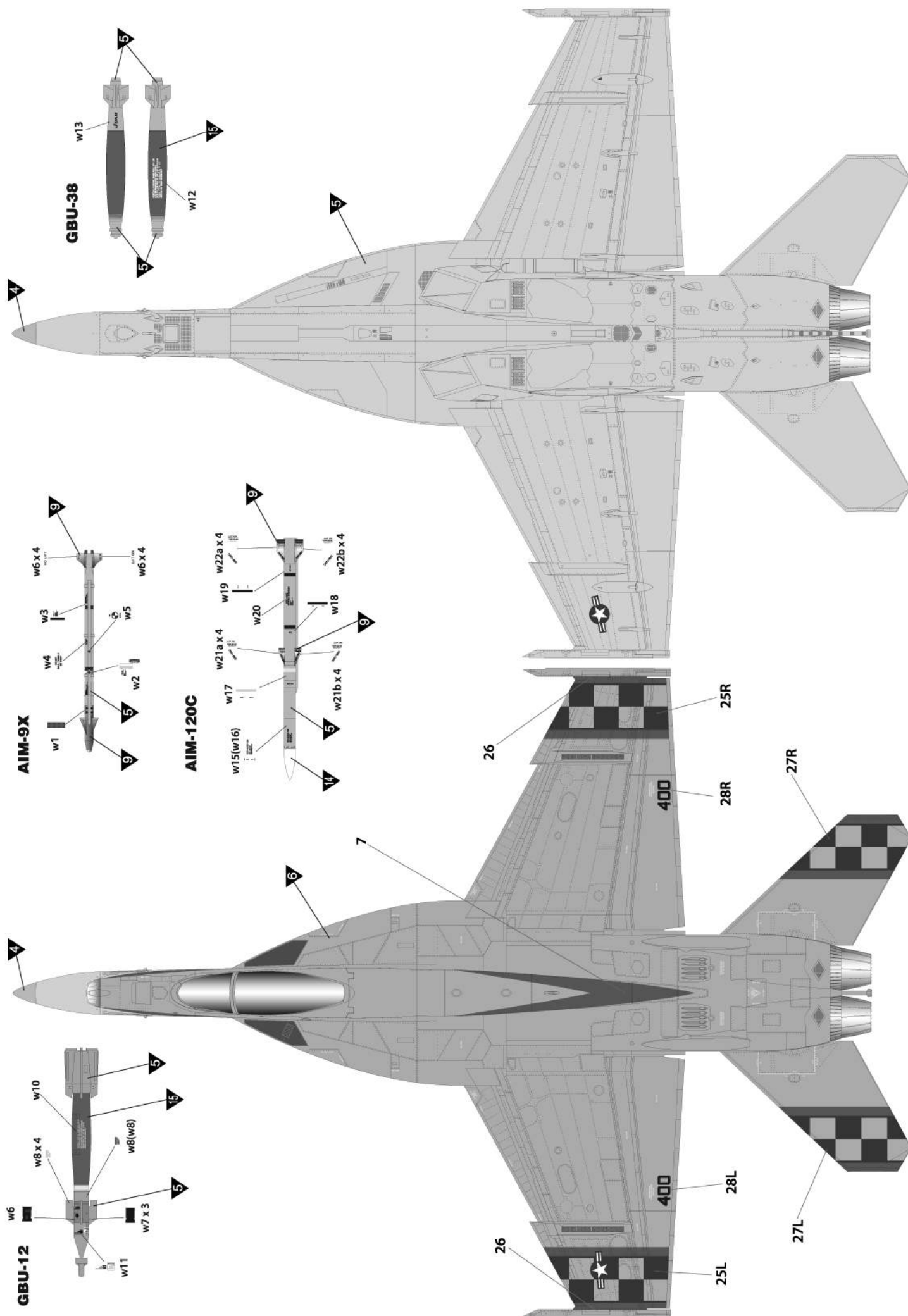

A

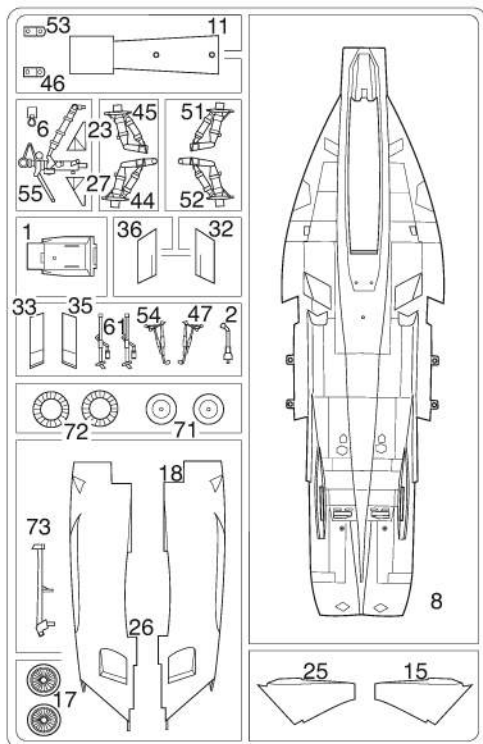

B

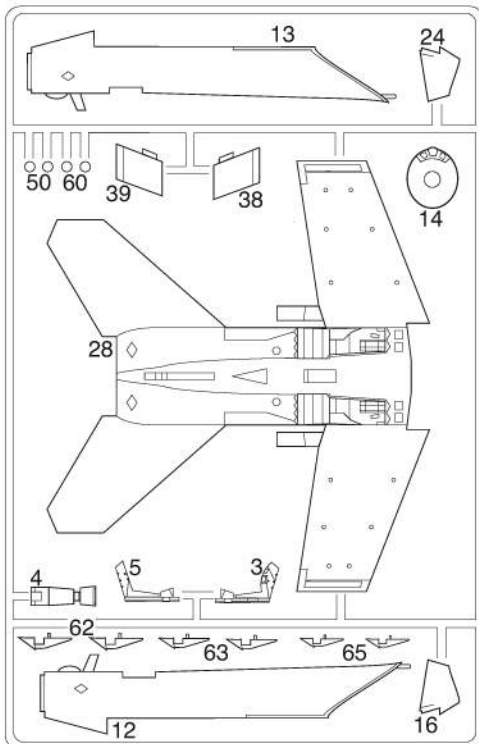

C

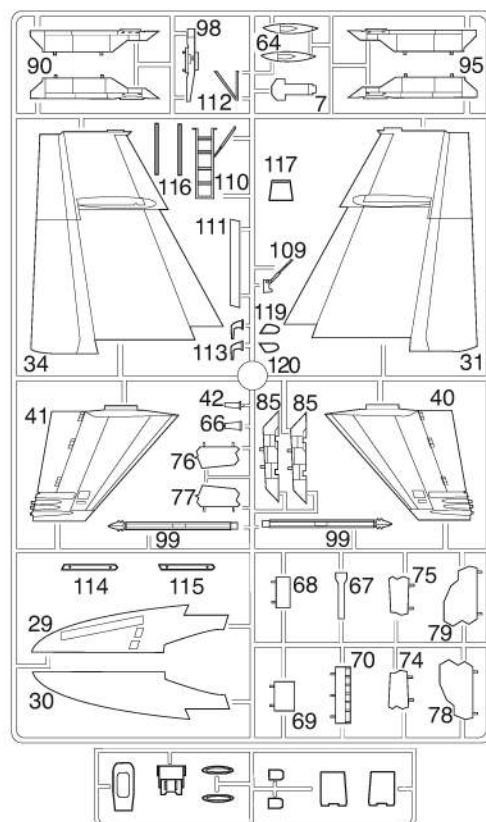

D

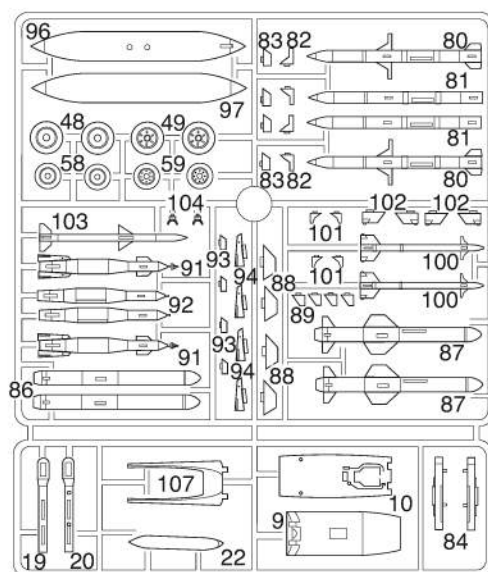

K

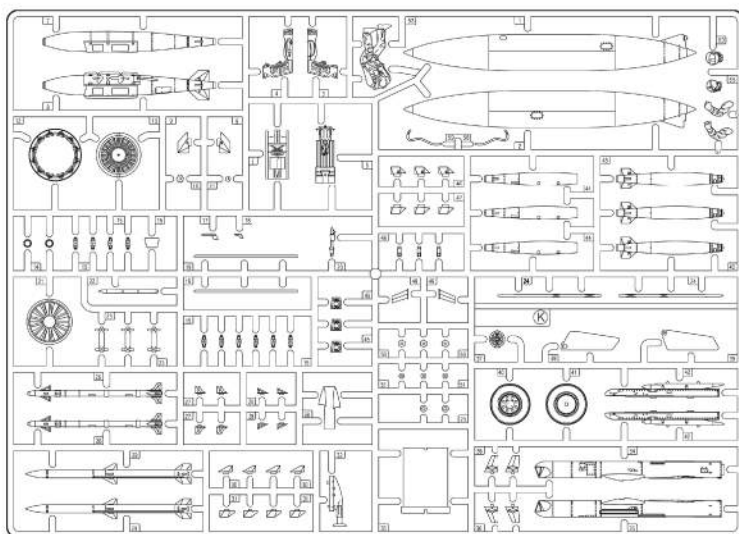

M

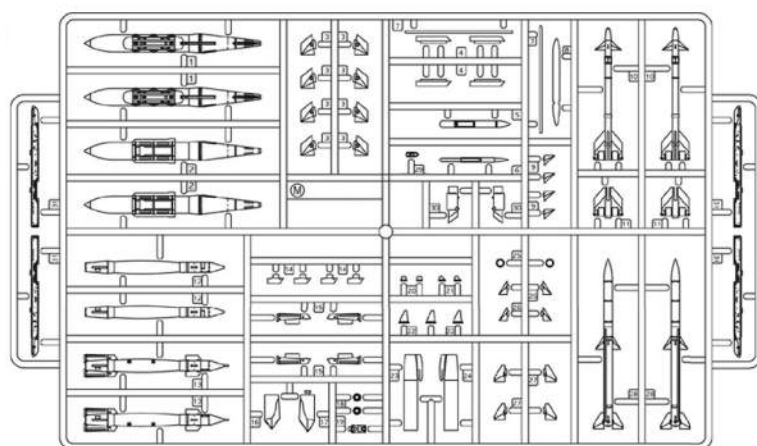

E

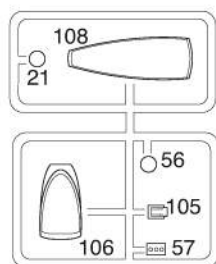

● Decal/전사지

● Unused parts/불필요 부품

C5, C6, C9, C11, C85, C114, C115, C119, C120, D80
D81, D82, D83, D84, D86, D87, D88, D89, D91, D92, D93
D94, D100, D101, D102, D103, K1, K2, K3, K4, K5, K6, K7
K8, K2 X2, K10, K11, K12, K13, K15 X4, K16, K17, K18, K20
K21, K22, K23 X3, K32, K33, K34, K35, K36 X4, K37, K38, K39
K40, K41, K42 X2, K43 X1, K44 X1, K45 X1, K46 X1, K47 X1
K48 X1, K49 X2, K50 X2, K51 X1, K52, K53, K54, K55, K56, K57
K58, K59, M1, M2, M3, M4, M5, M6, M9, M10, M11, M16, M17
M20, M21, M22, M23, M24, M25, M26, M27, M28, M29, M30, M31

ACADEMY
HOBBY MODEL KITS

ACADEMY
ACADEMY PLASTIC MODEL CO., LTD.
521-1, Yonghyeon-dong, Uijeongbu-si, Gyeonggi-do, Korea
고객상담문의: 031-850-8555