

■ 조립하기 전에

- 부품을 조립하기 전에 설명서를 잘 읽어본 후 조립한다.
- 부품을 자를 때에는 칼이나 니퍼로 깨끗이 잘라준다.
- 접착제를 사용할 곳과 사용하지 않는 곳에 주의하고 너무 많이 바르지 않도록 한다.

- 접착하기 전에 부품을 맞추어 확인한 후 조립한다.
- 에나멜 페인트나 접착제를 사용할 때는 창문을 열어 환기를 시키고 화기를 멀리한다.
- 사용 후 남은 부품은 어린 아이들의 손에 닿지 않도록 잘 처리한다.

1

FRONT 앞바퀴

REAR 뒷바퀴

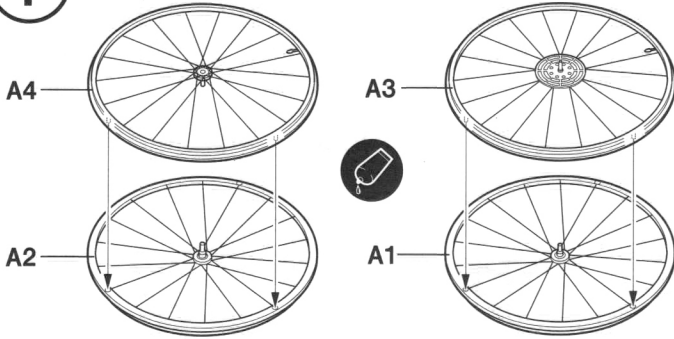
Tire
타이어

Tire
타이어

2

3

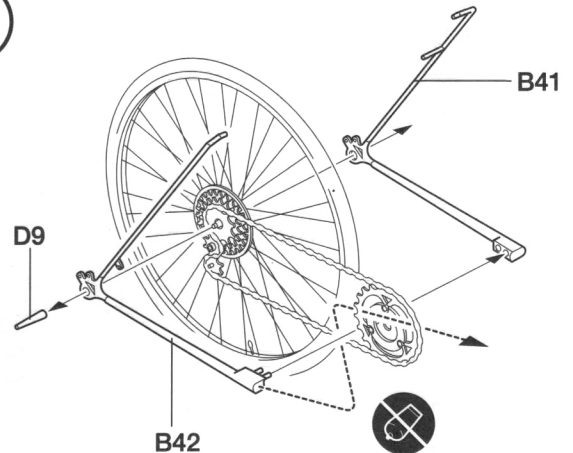
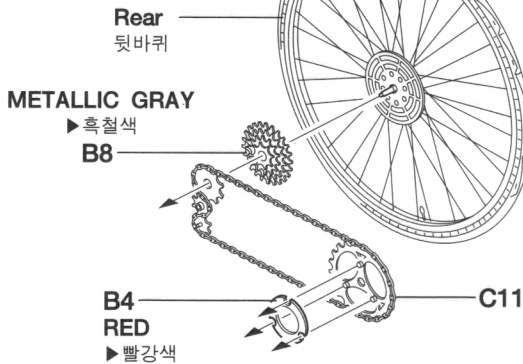

4

5

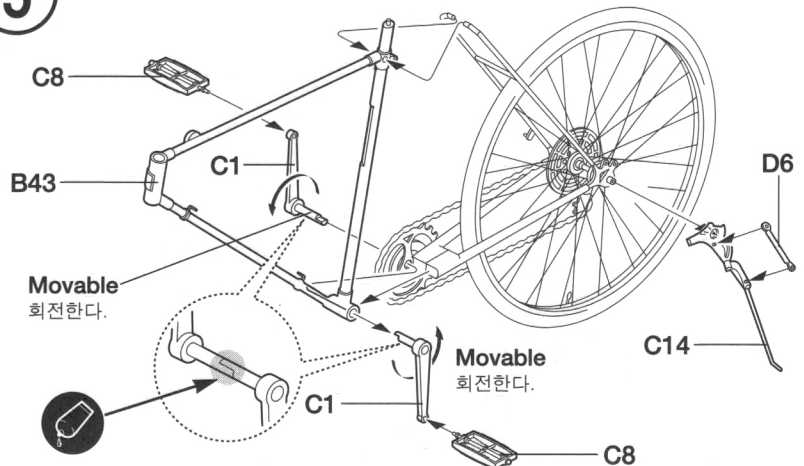
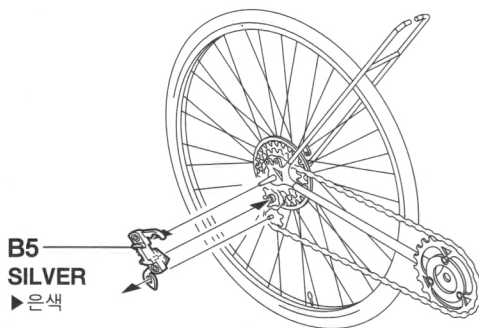

※ Remove plating from areas to cemented.
메기부품은 접착면의 메기를 긁어 낸 후 접착한다.



접착한다.
Cement Parts
Coller
Kleben
Pagar
Incollare
Color
Kleven



접착하지 않는다.
DO NOT cement
Ne pas coller
Couper
Nicht kleben
No pegar
Non incollare
Nao colar
Niet kleven



잘라낸다.
Cut away
Couper
scheiden
Cortar
Tagliare
Cortar
Snijden



선택한다.
Optional parts
Choix
Auswahlmöglichkeit
Eleccion
Scelta
Opcao
Keuze



수만을 조립한다.
Repeat operation
Repeter l'operation
Vorgang wiederholen
Repitir la operacion
Ripetere
Repitir a operacao
Herhalen

6

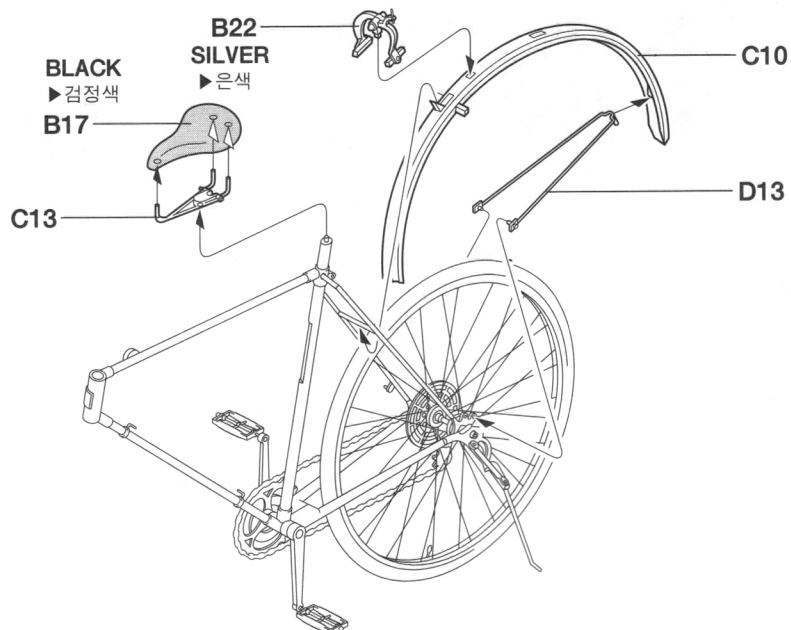

A

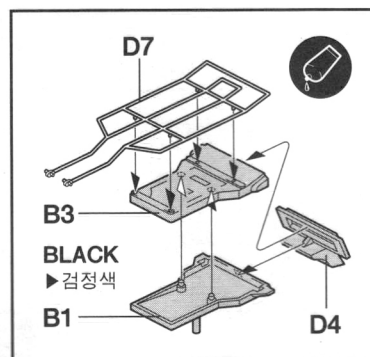

7

TYPE A

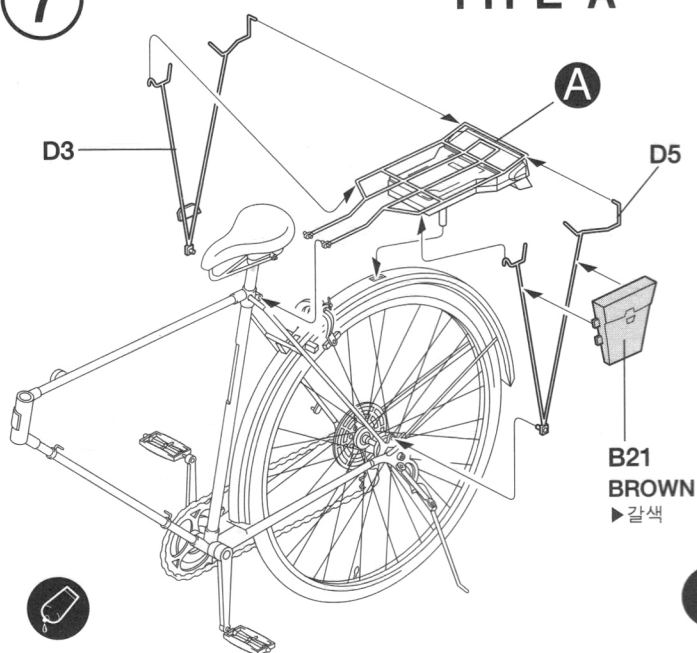

8

TYPE B

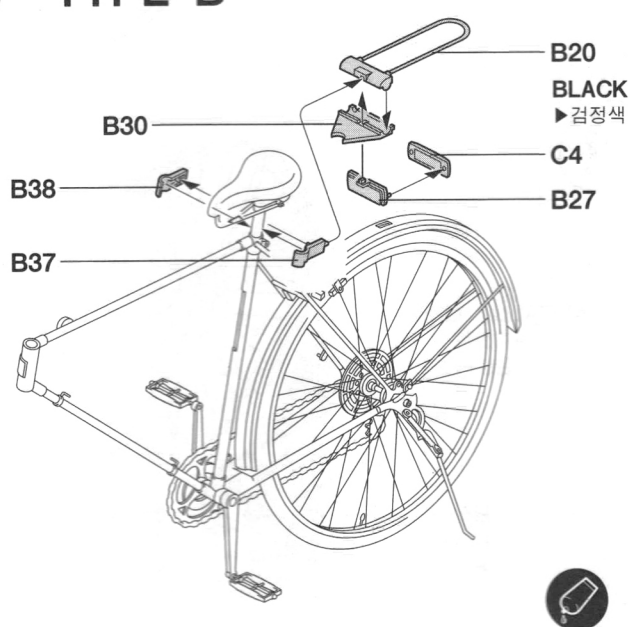

9

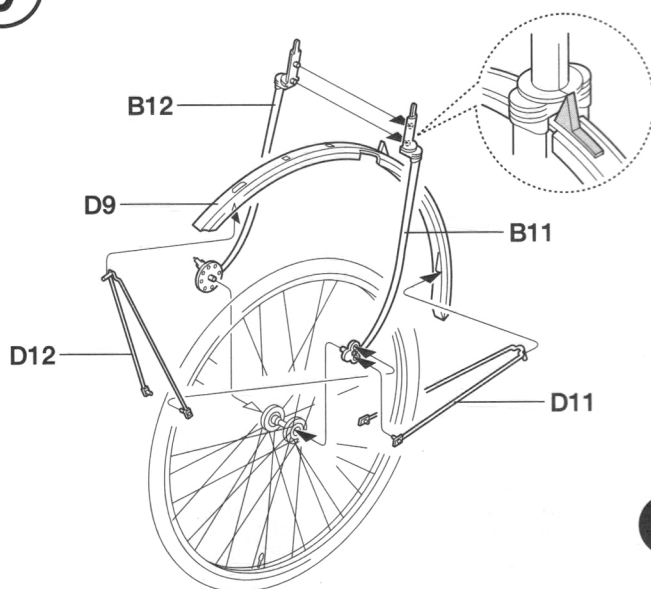

10

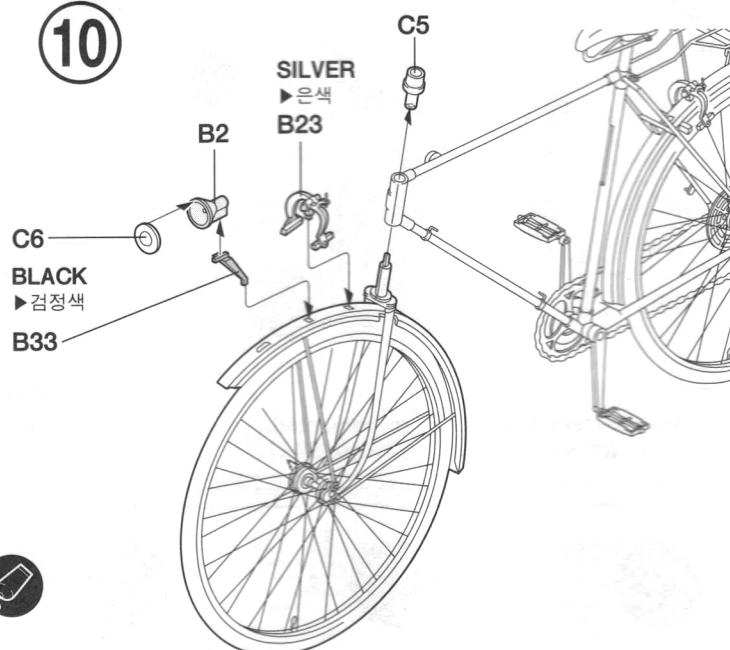

11

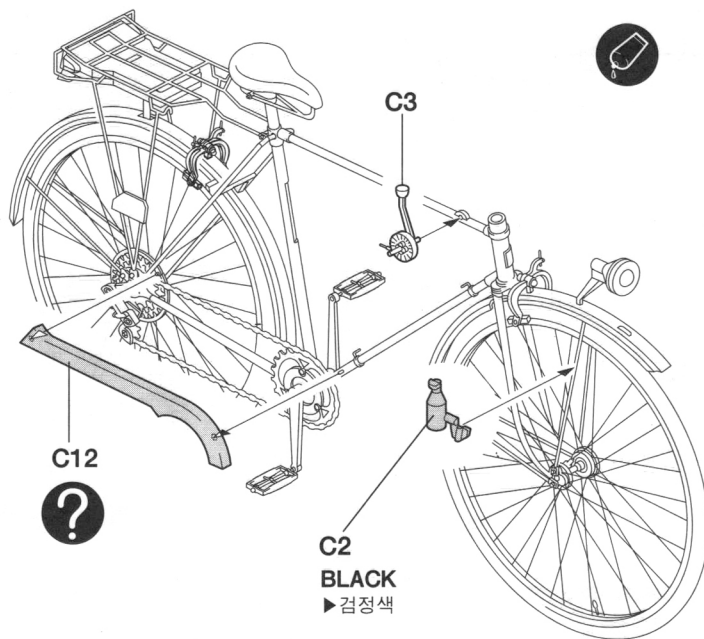

12

TYPE A

Overall: SILVER

전체: ▶은색

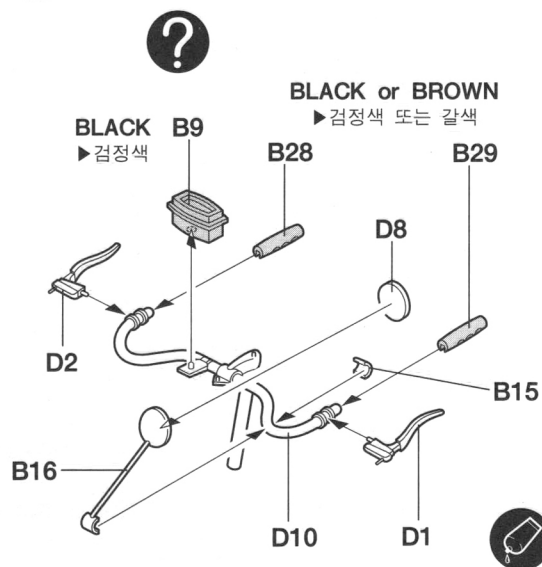

TYPE B-1



Overall: SILVER

전체: ▶은색

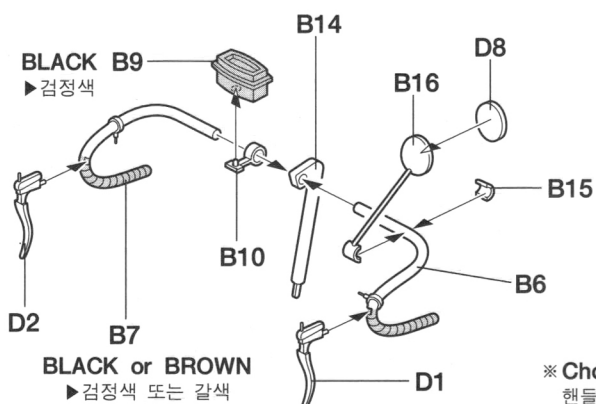

TYPE B-2



Overall: SILVER

전체: ▶은색

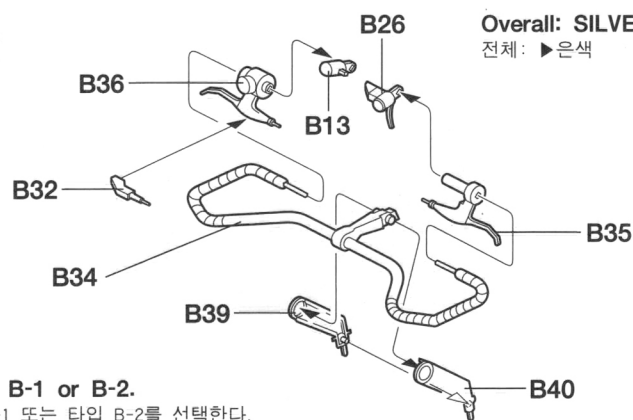

※ Choice to type A, B-1 or B-2.

핸들은 타입 A, 타입 B-1 또는 타입 B-2를 선택한다.

13

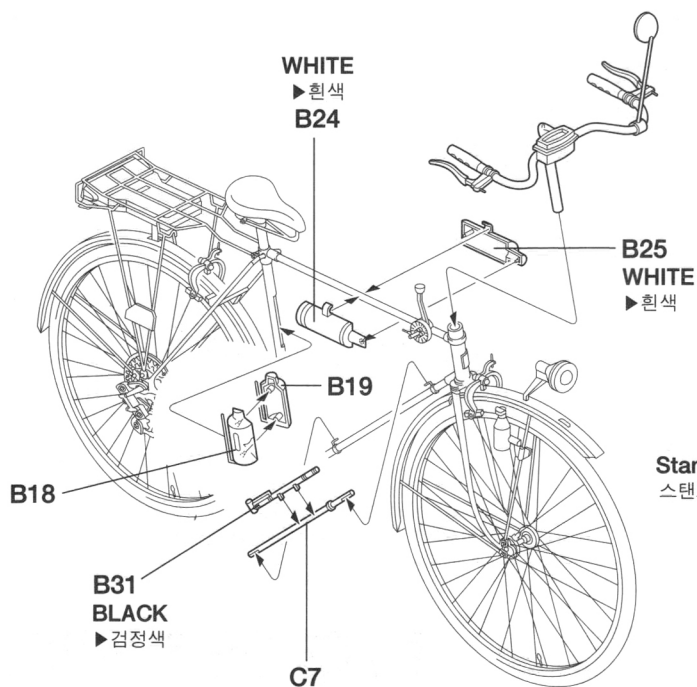

14

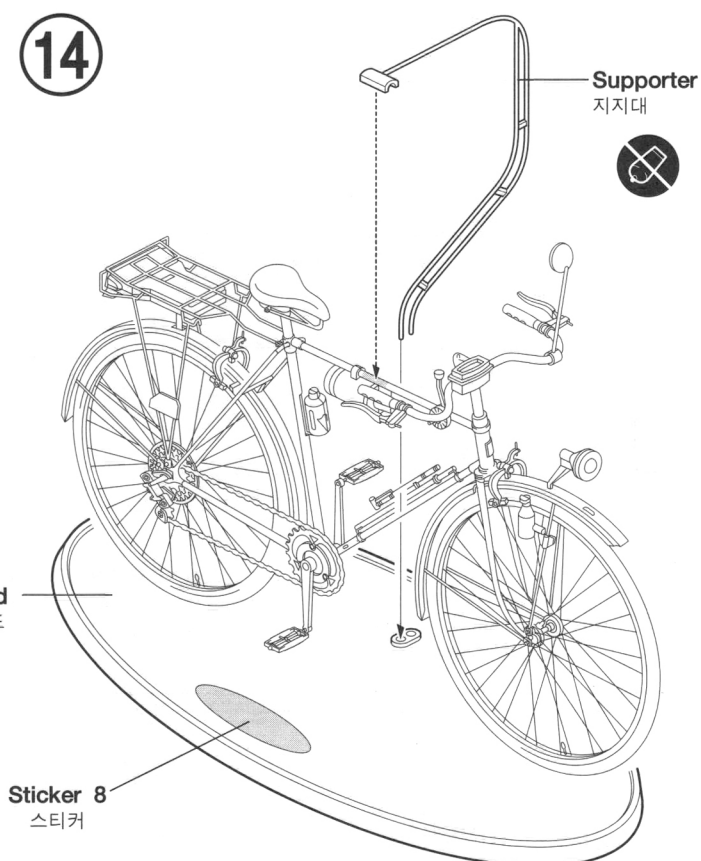

Wiring 배 선

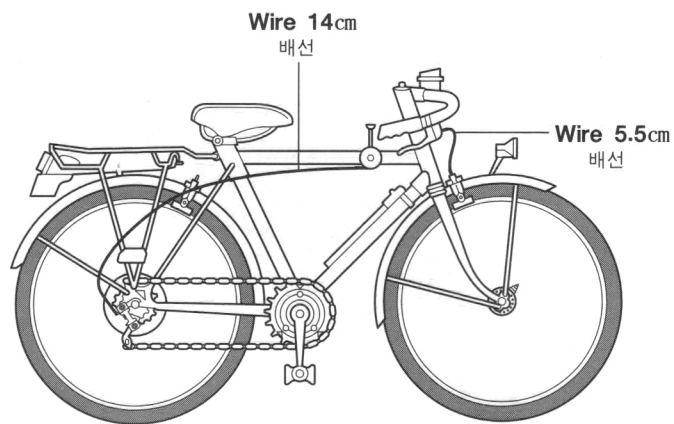
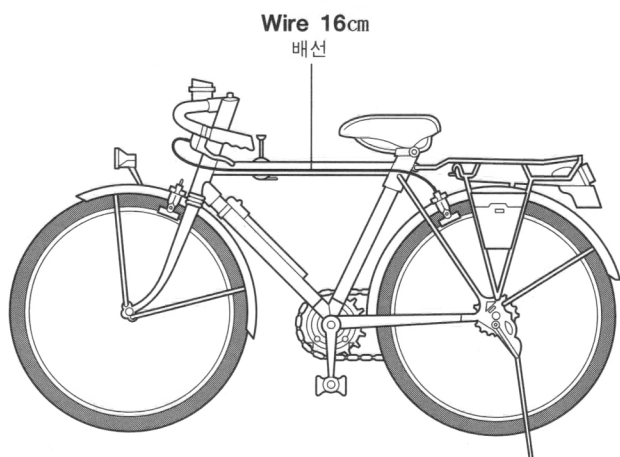

● Notice : Please refer to picture on side of box how to place stickers. (스티커 붙이는 방법은 상지옆면의 그림을 참조하세요.)

Parts locating diagram 부품도

A

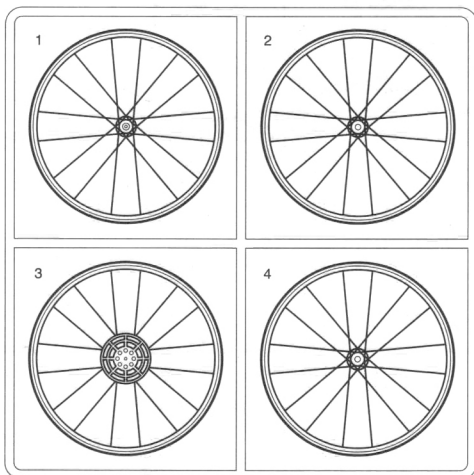

B

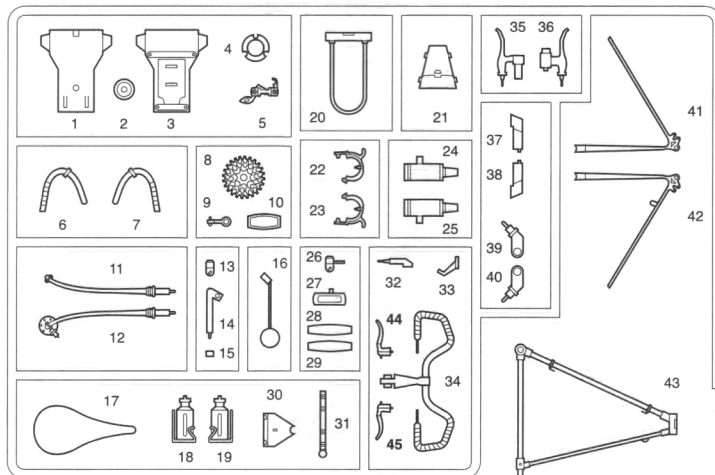

C

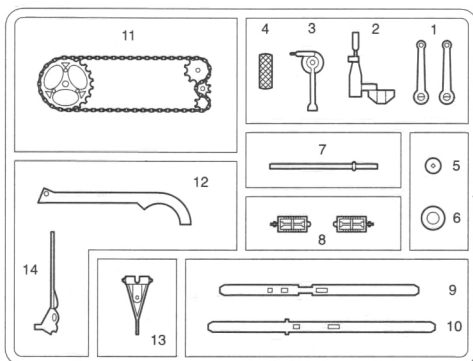

D

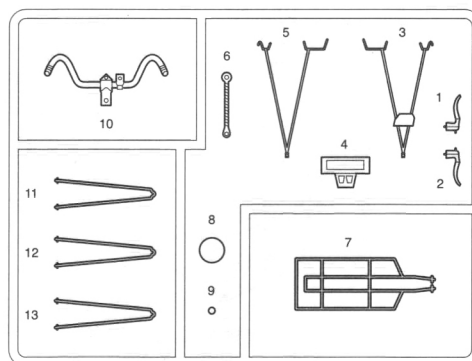

- DISPLAY STAND 받침대 × 1
- TIRE 타이어 × 2
- MANUAL 설명서 × 1
- WIRE 배선 × 1
- SUPPORTER 지지대 × 1
- STICKER 스티커 × 1
- CEMENT 접착제 × 1

#1540
MA038

©1998 Academy Plastic Model Co., Ltd.

ACADEMY
HOBBY MODEL KITS

ACADEMY
ACADEMY PLASTIC MODEL CO., LTD.
521-1, Yonghyeon-dong, Uijeongbu-si, Gyeonggi-do, Korea
고객상담문의 : 080-969-7000