

7

※Strictly follow the assembly order as shown by the numbers.

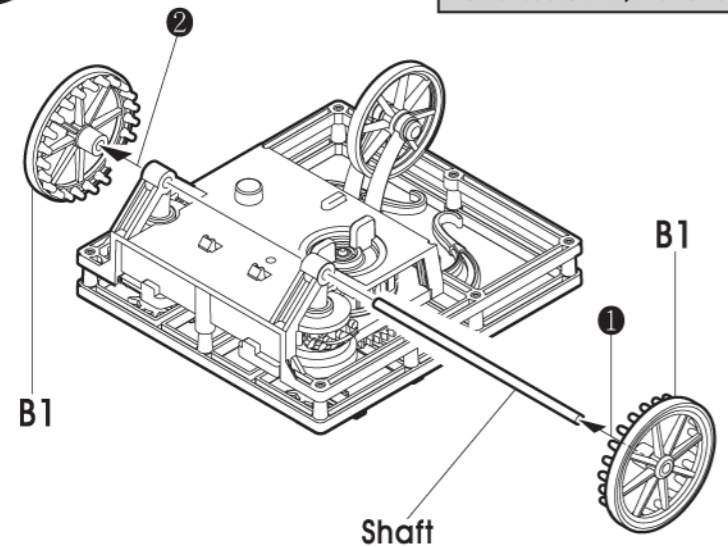

8

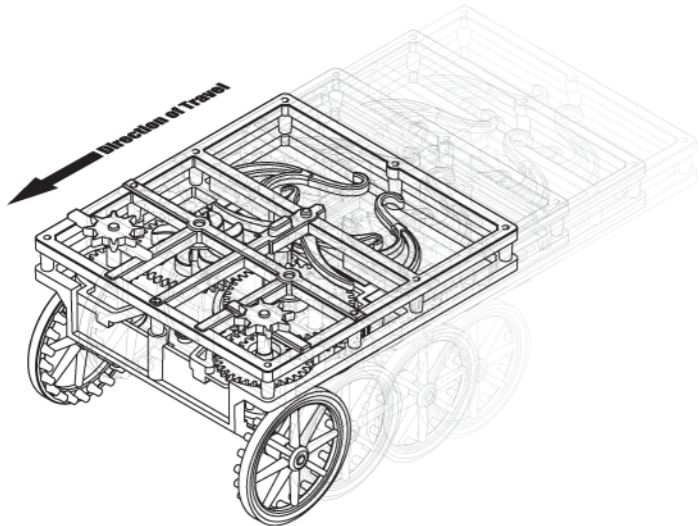

■Finished Model Views

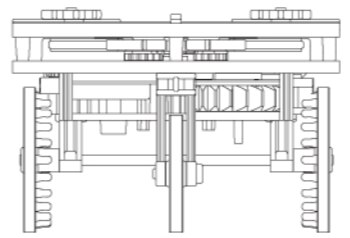
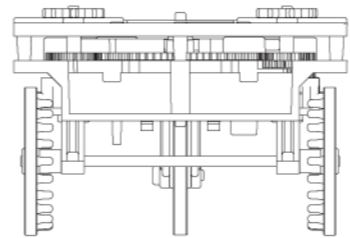
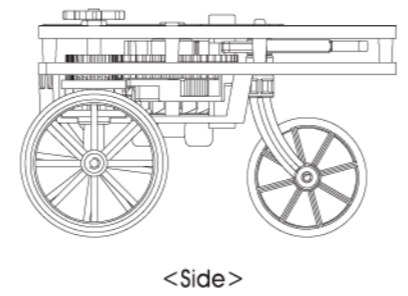

■How to Operate

※Follow these 2 step in the order shown.

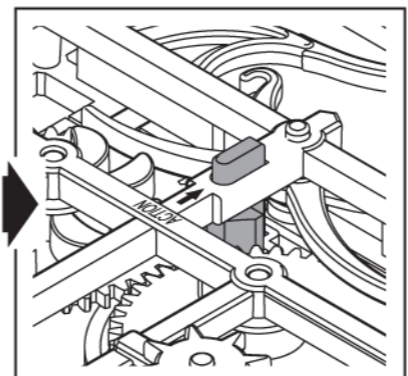
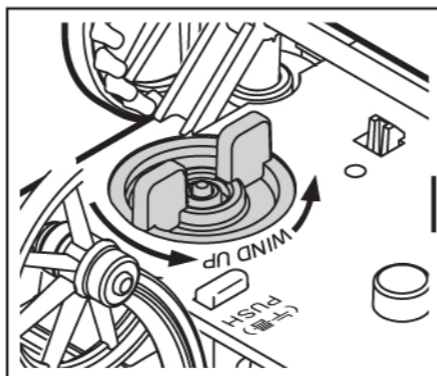

1. Press the "PUSH" button down to lock, then turn the wind up knob.

2. Place model on the floor on the wheels. press "ACTION" button down to operate.

※ When Spring Winding Unit stops, it is fully wound. Do not force beyond this point.

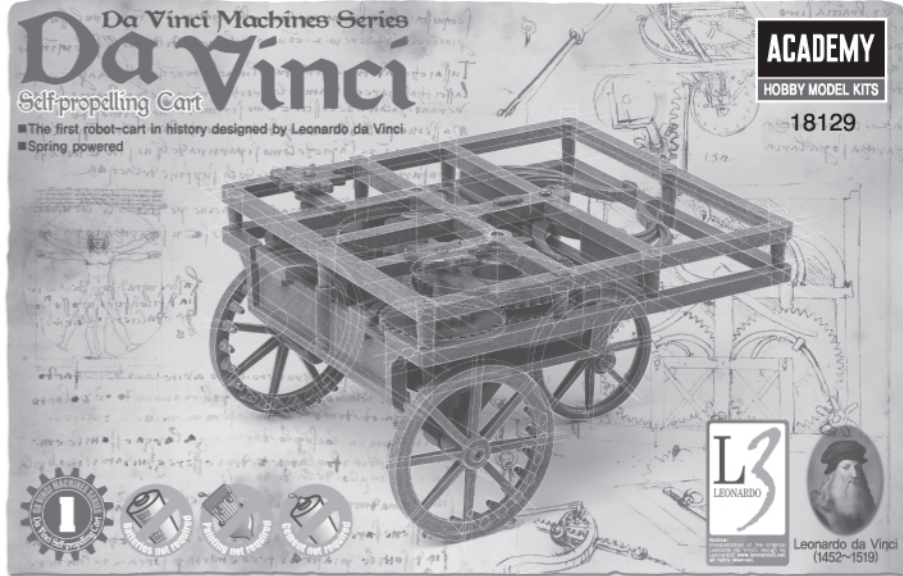

⚙️Parts Locating Diagram

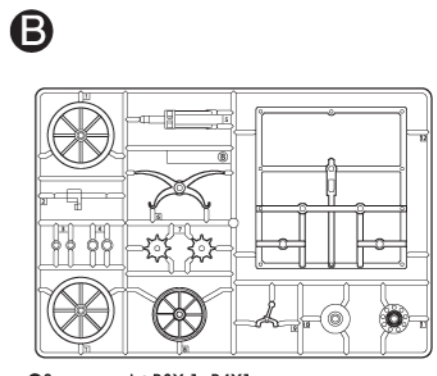
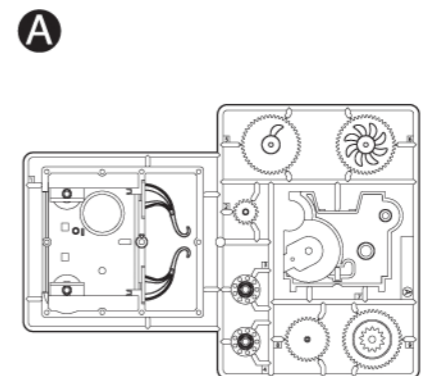

●Spare parts: B3X 1, B4X1

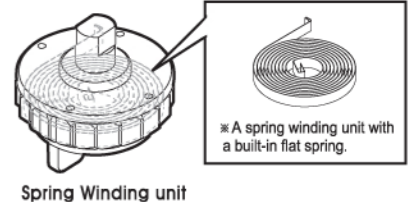
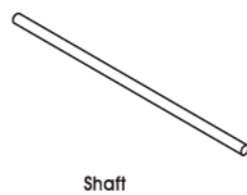

1

Spring Winding Unit

A1

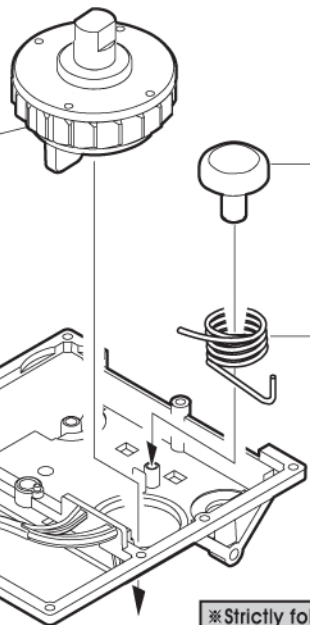

B4

Spring

※Be careful to insert spring as diagram.

※Strictly follow assembly as shown in diagram.

2

A

B11

A2

B

B10

A3



3

B9

A

A7

※Assemble this part first and be careful to follow the direction shown.

※As shown, put inside hole first and push tightly.

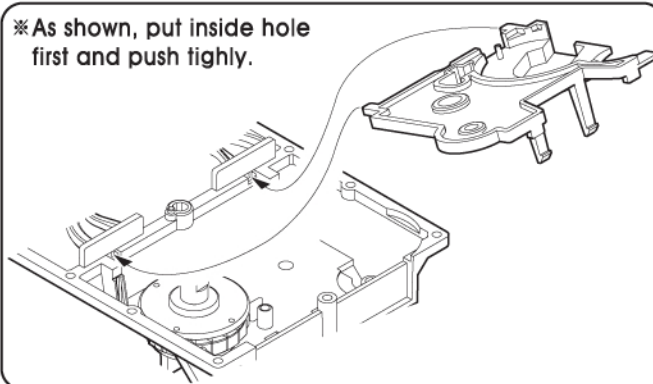

※Strictly follow assembly as shown in diagram.

4

※Strictly follow the assembly order as shown by the numbers.

3

A8

A5

1

2

A6

4

B2



※Be careful and make sure all the gear cogs are aligned properly.

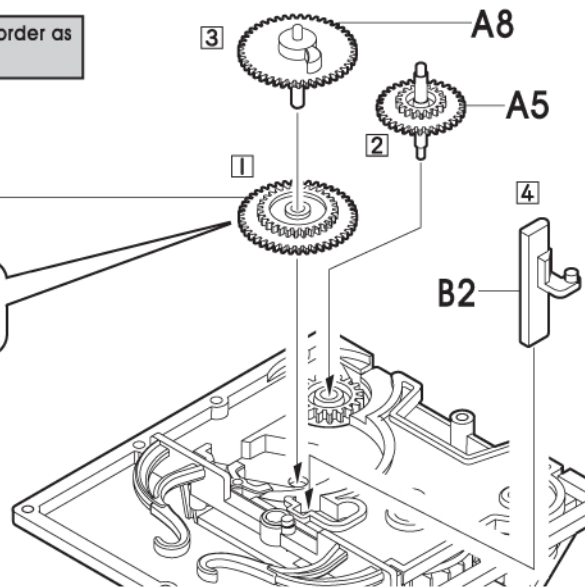

5

※Strictly follow the assembly order as shown by the numbers.

A9

1

Short

4

Long

B6

3

※Be careful and make sure all the gear cogs are aligned properly.

B5

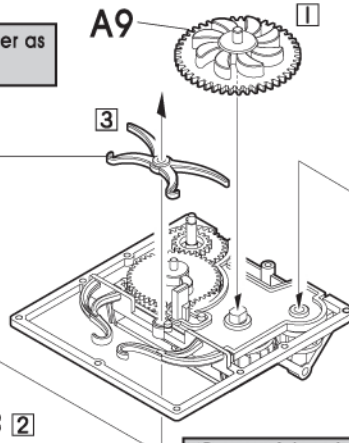

B8

2

B3

2

2

6

B12

B7

