

1

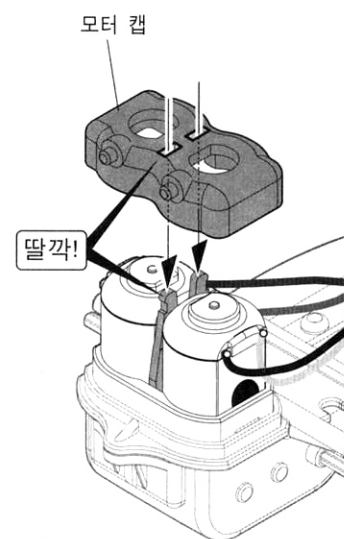

2

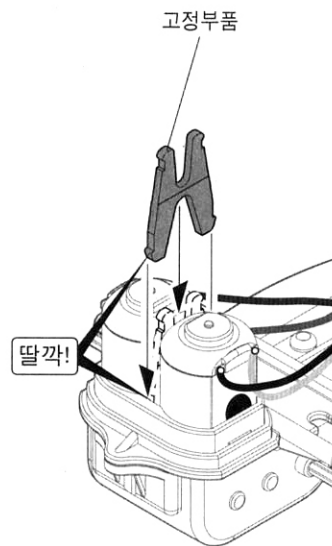
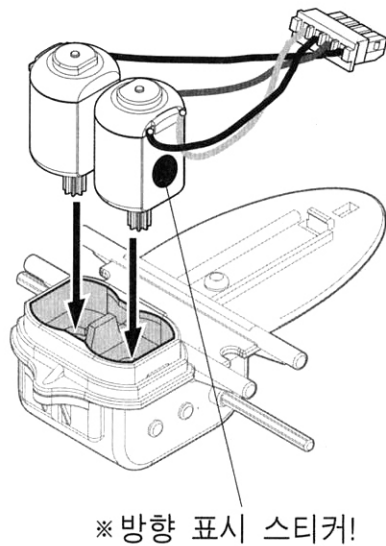
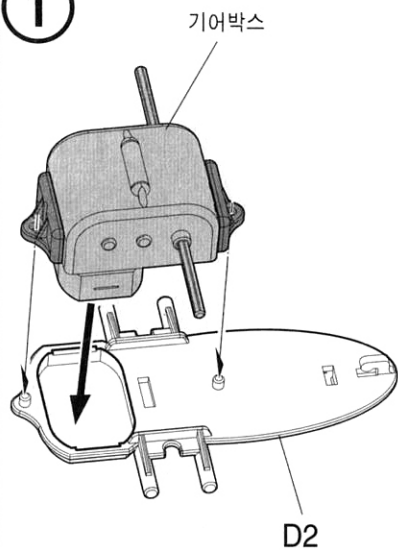
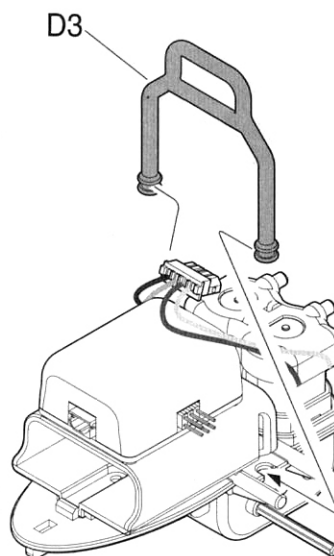
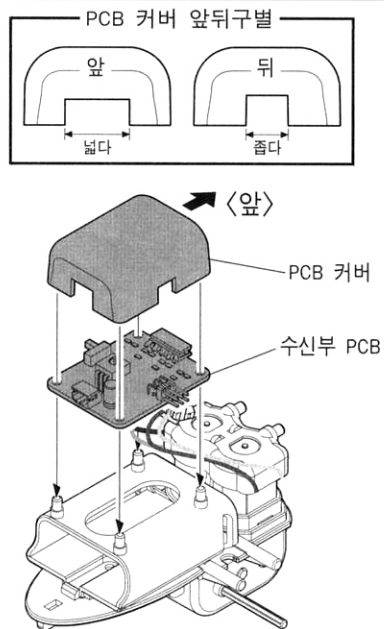
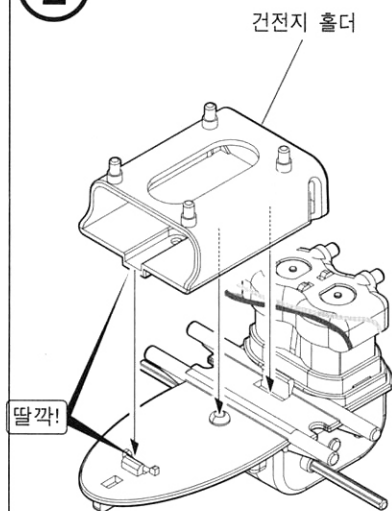

3

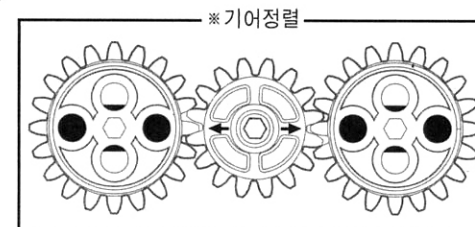
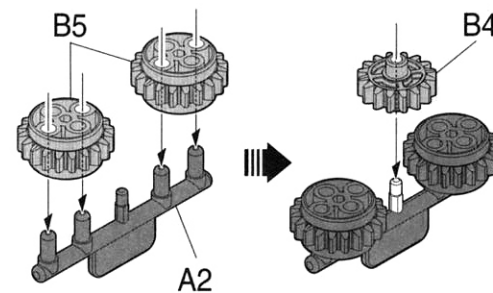

4

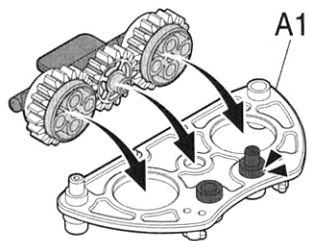

※방향에 주의하세요.

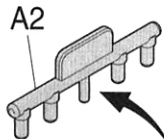

※기어조립후 A2부속을 제거 해 주세요.

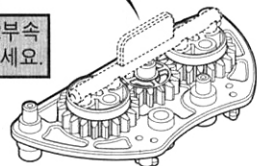

X2

※2개를 만들어주세요.

5

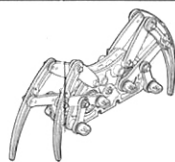

X2

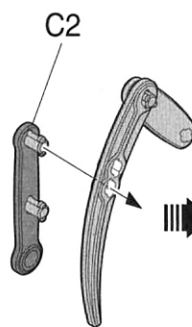
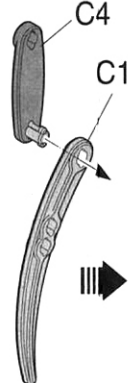

반대측도 조립 해 줍니다.

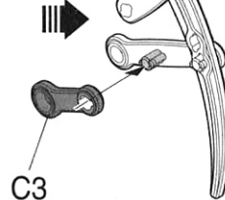
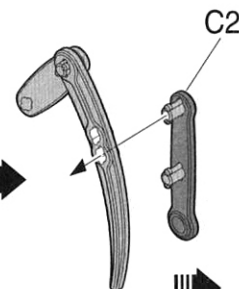
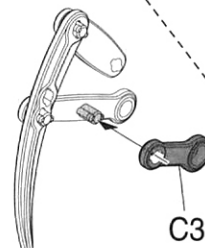

6

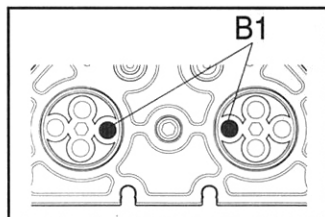
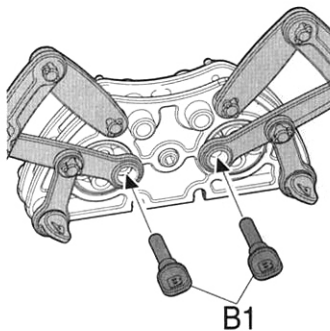
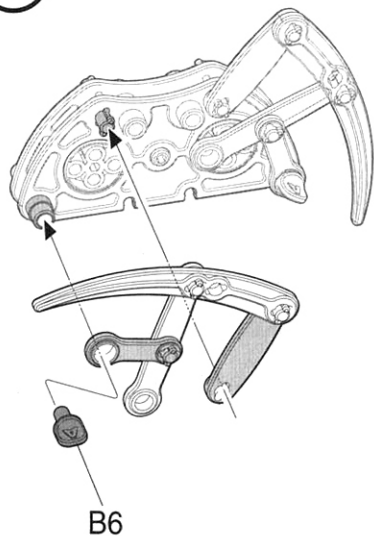

7

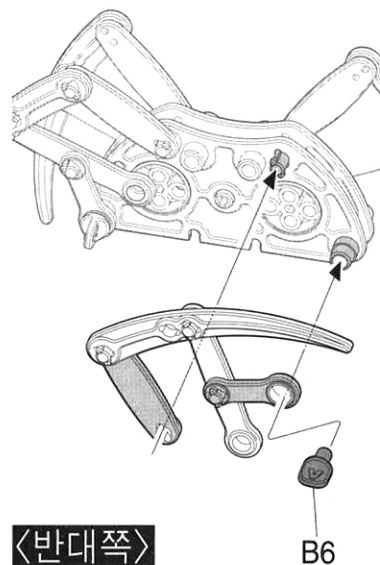

<반대쪽>

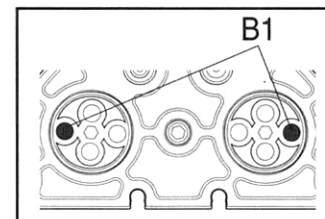
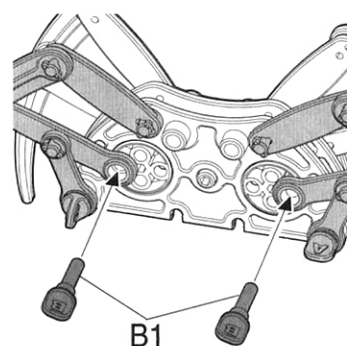

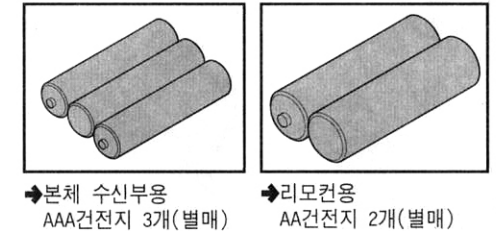
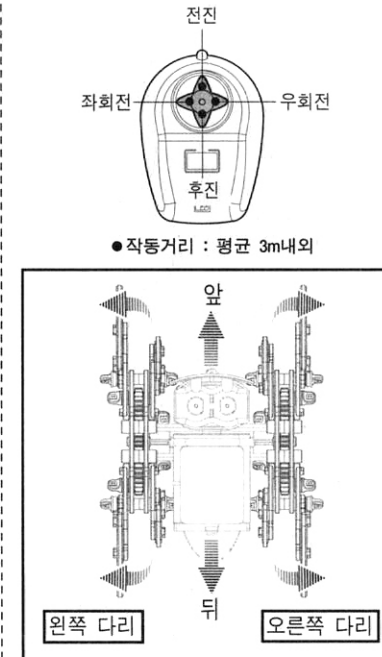
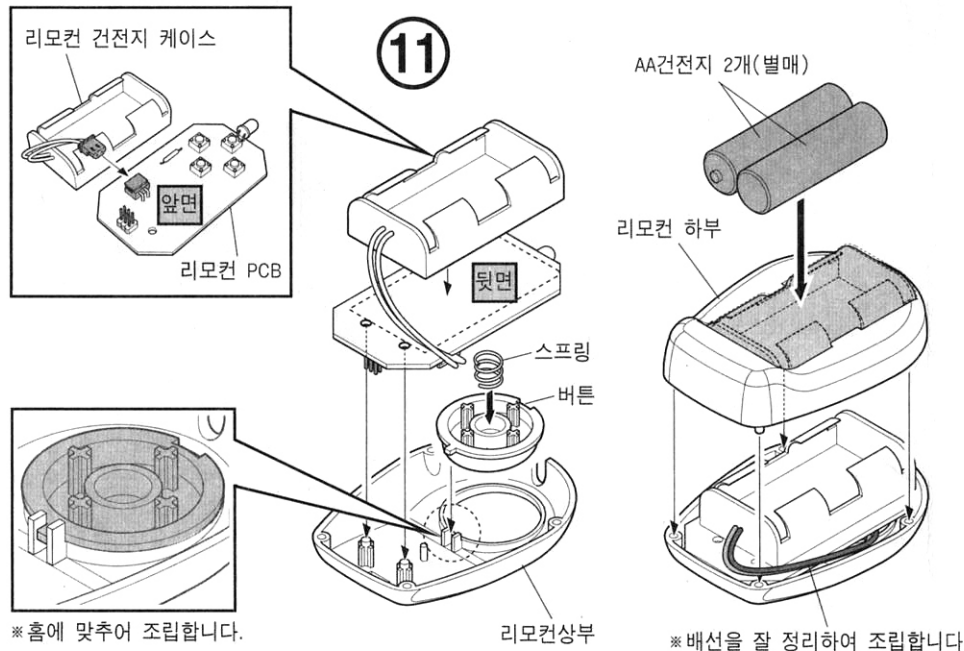
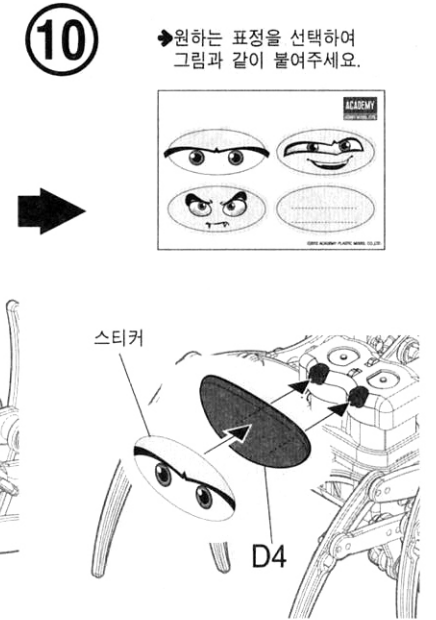
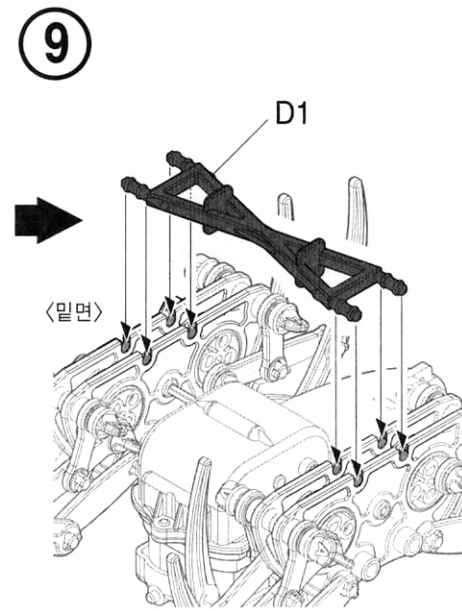
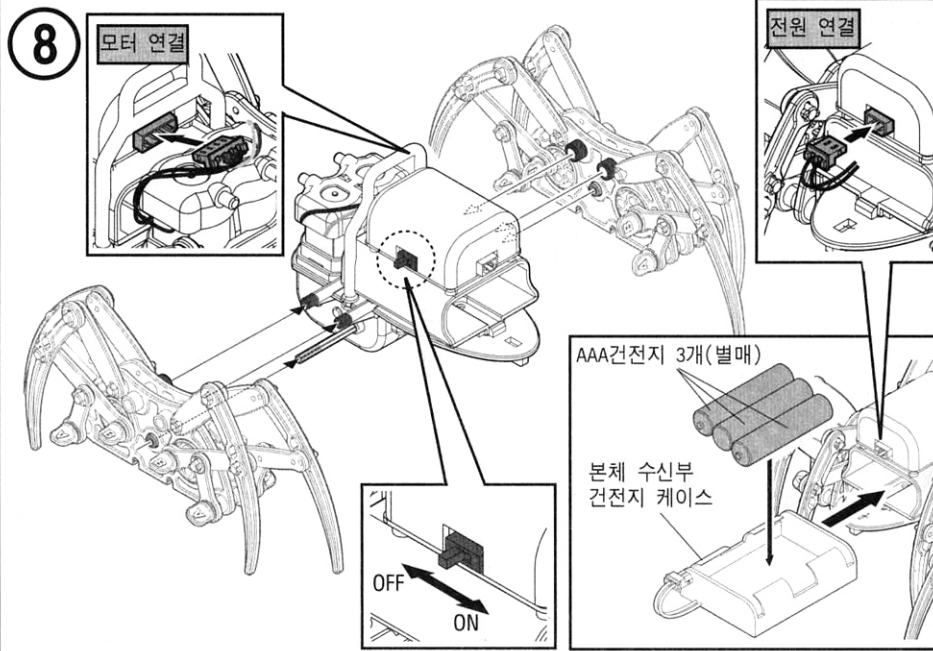

* 작동중 작동거리가 급격히 짧아지고 오작동이 발생하면 수신부(작동부) 건전지를 교환하여 주세요

* 수신부(작동부)는 절전기능이 있어 장시간 사용하지 않으면 자동으로 꺼집니다. (재사용 시에 스위치를 다시 껐다 켜야 합니다.)

* 주의
적외선 무선방식의 특성상, 태양광이나 삼파장 램프 아래에서는 정상적인 작동에 영향을 줄 수 있습니다.

■ 스파이더로봇의 보폭 조정

좁은보폭 선택

넓은보폭 선택

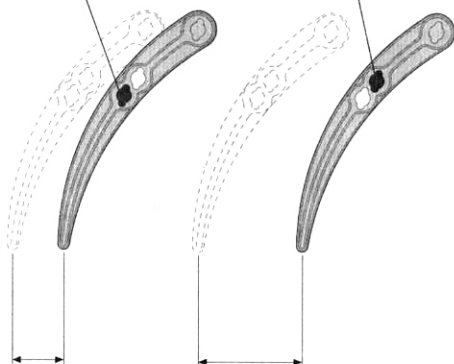

★보폭이 좁다.

★보폭이 넓다.

■ 실리콘 튜브 끼우기(선택조립)

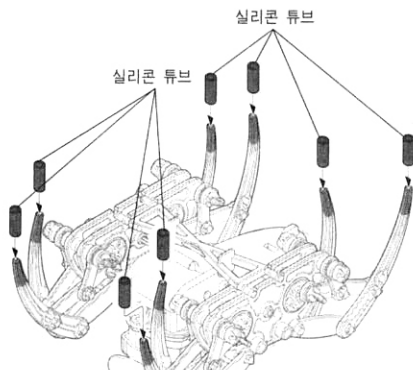

※실리콘 튜브를 끼우면 바닥과의 마찰력이 증가하여 건전지사용시간이 줄어 들 수 있습니다.

1cm

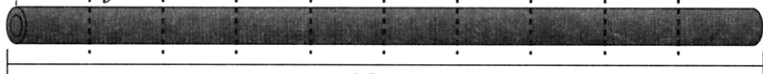

10cm

※그림에 맞추어 1cm간격으로 8개를 잘라서 다리부분에 끼워 주세요.

■ 채널 설정법

※리모컨과 수신부의 똑같은 위치에 캡을 끼워 채널을 설정합니다.
(채널설정시 전원을 끄고 캡을 끼웁니다.)

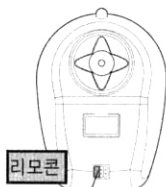

리모컨

주파수 설정캡



본체 수신부

주파수 설정캡

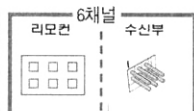
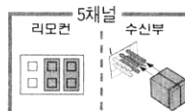
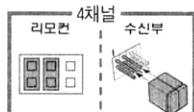
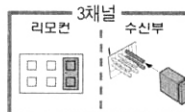
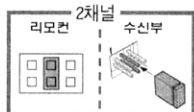

▶본 제품은 2명에서 최대 6명까지 동시에 각각 다른 채널로 설정하여 게임을 즐길 수 있습니다.



★무선 스파이더로봇 다리에 실리콘 튜브를 끼워서 경사오르기 게임을 해보세요.

●본 제품 구입 후 소비자 과실이 아닌 제품자체의 결함, 하자등 피해 발생시 신중교환 및 A/S를 통하여 보상하여 드립니다.

■ A/S 접수 : www.academy.co.kr/080-969-7000

■ 단체구매 문의 : 학교, 단체, 교육용, 캠프용 / (031)850-8500

ACADEMY
HOBBY MODEL KITS

ACADEMY
ACADEMY PLASTIC MODEL CO., LTD.
52111 Yongin-si, Gyeonggi-do, Korea
고객상담센터 : 080-969-7000